

INVITATION FOR BIDS

CCK-2590.2-1-25

Whitehall Classroom Building Renovations - Demolition

PROJECT #2590.2

ADDENDUM # 1

07/01/2024

**IMPORTANT: BID AND ADDENDUM MUST BE RECEIVED BY 07/10/2024 @ 3:00 P.M. LEXINGTON, KY TIME**

Bidder must acknowledge receipt of this and any addendum as stated in the Invitation for Bids.

**ITEM #1: BIDDER NOTICES**

**AFTER submitting the bid at the bid clerk's desk**

322 Peterson Service Building  
411 S. Limestone  
Lexington, KY, 40506

Contractors should relocate to the Bill Gatton Student Center, room 330A/B across Limestone street, where the bid results will be publicly read. No bids will be accepted at this location.

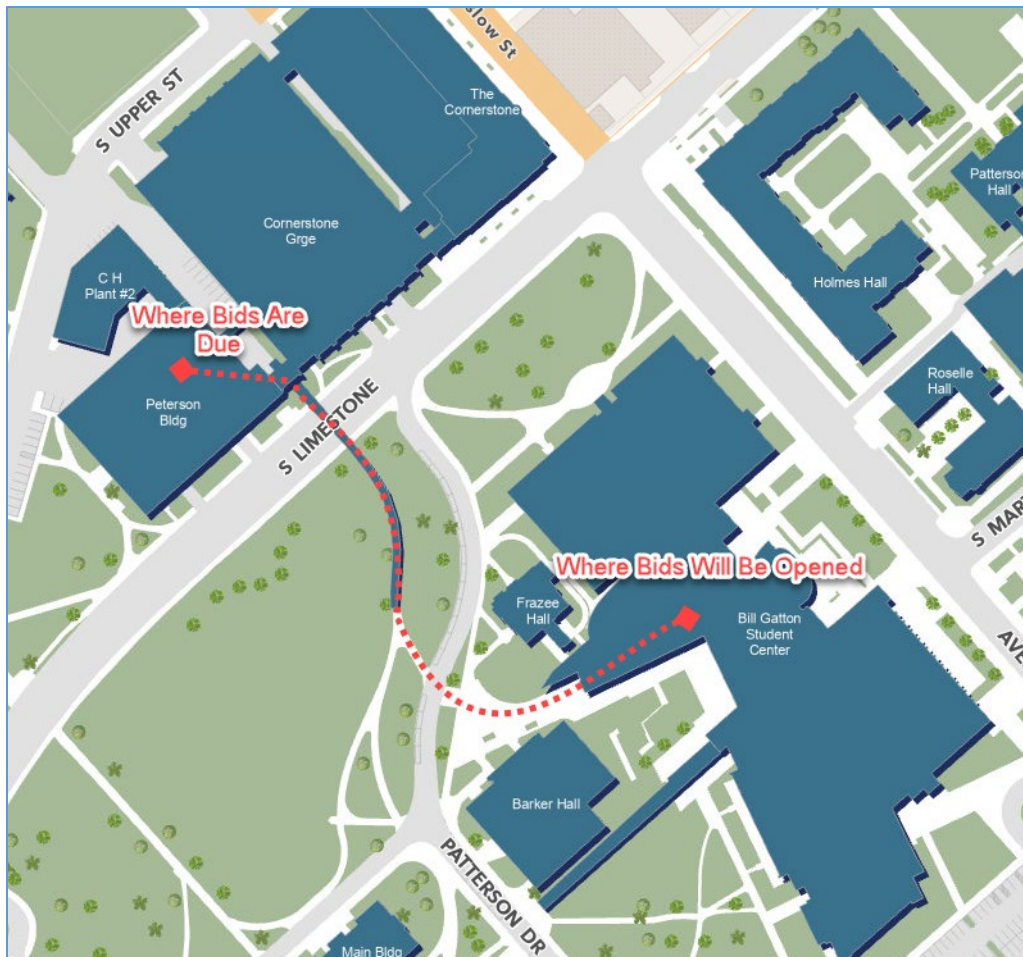

**ITEM #2: CLARIFICATIONS AND MODIFICATIONS TO THE BIDDING DOCUMENTS:**

Bidders are instructed to review and incorporate the enclosed Q&R document into their bid.

Updated Bid Forms are enclosed for TP-08 and TP-09, which are additional combo bid options to TP-07.

Pepper Construction and Sherman Carter Barnhart Addendum #1 is enclosed.

**OFFICIAL APPROVAL**  
**UNIVERSITY OF KENTUCKY**

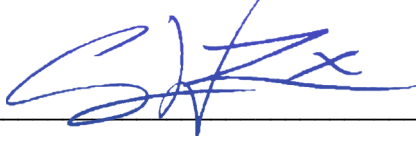

---

Corey W. Leslie/ Construction Procurement

**SIGNATURE**

---

---

Typed or Printed Name

## CCK#2590.2-1-25 Whitehall Classroom Building Renovation - Demolition Package

## Question and Response Log

Question Deadline 06/21/2024

#	Question	Response
1	Item #84: Please clarify that all dumpsters on BP1 are to be carried by TP-01 Demo	The demolition contractor is to provide dumpsters for Bid Package 1 work.
2	Please clarify TP-01 is responsible for OSHA compliant slab opening/hole covers (scope item: HH.vi.)	Holes created during the demolition process are to be covered in compliance with OSHA requirements by the contractor creating the hole. If existing holes are shown on the drawings not created by the demolition contractor are to be covered by the General Trades Contractor.
3	Please clarify TP-01 is responsible for OSHA compliant temporary fall protection/barricades. Permanent barriers/railings will be provided by others (scope item: V.)	For the demolition scope of work if the demolition contractor is creating a fall hazard the area will need to be barricaded to keep people out and making the condition safe. Each trade to provide their employees with personal fall protection and anchor. Permanent barriers is intended to be longer term fixed construction barriers and rails created from lumber and installed by General Trades Contractor, and not final product.
4	Does scaffold system, buck hoist, or trash chute require foundations or specialty equipment for install (lull, crane, lifts)? If so, please provide requirements for each or consider an allowance for bidding purposes.	Please reference Exhibit K for additional scaffolding details and requirements. Structural Engineer to provide max loading for areas where scaffold is to be installed.
5	Is trash chute rental duration intended to match the scaffold system, including additional (2) two months beyond contract?	The intent is that the scaffold system / chutes / Buck hoist is to be covered for the duration of the project, and through the transition into BP#2. Any added costs or savings over this duration will be adjusted via change order.
6	Will the buck hoist be installed concurrently with scaffolding, or at a later date? Project schedule does not define installation date and logistics note "buck hoist will not available during BP1 demo work".	The intent is that the buck hoist is to be scheduled when level 1 concrete demolition starts as it will start to come out through the basement. During the time supporting the slab starts at line item 39.
7	Please clarify trash gondolas, trash cans, and fire extinguishers are provided for TP-02 contract duration only?	These are to be provided for the full duration of Demolition Bid Package 01.
8	Site fencing "on concrete surfaces are to be mounted to plastic barriers", is assumed to be water-filled jersey barriers. Per logistics plan, nearly all of site fence is to be installed in paved areas. Please clarify if all fencing outside of lawn areas must be barrier fencing or if portions can be driven-post chain link. If possible, provide logistics plan markup or define footage of fence types required.	See updated logistics plan for fence types. Dashed blue line indicates post driven. Prior to driven posts this contractor shall implement Pepper's Underground Utility Damage Prevention Program. Which would include underground utility locating.
9	Please clarify site fencing vehicular and personnel gates: quantity of each, type of vehicular gates, sizes of gates.	See revised Logistics Plans. Gates larger than 10' are to include two swinging leaves unless coordinated otherwise in the field.
10	Scope Item G. i. : Please define areas or SF of flooring protection required. Plans do not define areas where existing flooring is to be protected	The intent is to protect the existing terrazzo flooring to remain, which occurs in the corridors. The area to be protected in approx.. 22,000SF
11	Scope Item B. i. : Will laborers be required/permitted during abatement scope, or only during demolition?	Laborers will not be required during the Abatement Scope of Work.

**ADDENDUM NO. 1  
UNIVERSITY OF KENTUCKY  
WHITEHALL RENOVATION  
DEMOLITION PACKAGE  
UK NO. 2590.2  
SCB PROJECT NO. 2302**

TO: ALL PLAN HOLDERS

FROM: Sherman-Carter-Barnhart Architects, PLLC  
144 Turner Commons Way, Suite 110  
Lexington, KY 40508

DATE: June 26, 2024

The purpose of this Addendum is to clarify the requirements of the Plans and Specifications.

The bidders shall be governed by the information in this Addendum as if included in the Plans and Specifications.

This Addendum does hereby become a part of the Contract Documents.

Each bidder shall acknowledge receipt of this Addendum on the space provided in the Bid Form. This addendum consists of Seven (7) pages.

**PROJECT MANUAL VOLUME 1**

**A. SPECIFICATIONS**

1. Refer to Specification Section 311000 – Site Clearing. Delete section in its entirety. Modify index accordingly.

**B. ARCHITECTURAL DRAWINGS**

1. Refer to Sheet AD1.1. Replace Sheet AD1.1 with attached revised Sheet AD1.1.

**C. ABATEMENT DRAWINGS**

1. Refer to Sheet ASB-1. Replace Sheet ASB-1 with attached revised Sheet ASB.1.

**D. MECHANICAL / ELECTRICAL / PLUMBING DRAWINGS**

1. Refer to Sheet M0.3: Add following General Note to Sheet M0.3 as follows:

The existing controllers on the 2<sup>nd</sup> and 3<sup>rd</sup> floor of White Hall have been removed and salvaged by the owner. The basement has selective demolition and portions of it will remain in operation throughout the entire construction duration. No controllers should be removed on the 1<sup>st</sup> or basement levels. On levels 1, 2, and 3 the controls wiring from the existing equipment (that is being demolished) needs to be demolished back to its source, as future connections will not be in the same locations. For any controllers that are not demolished, contractor to ensure existing communication lines are made continuous. Contractor to notify UK Facilities Management and

Controls Engineering Department (859) 323-6012, before demolishing existing controllers. After each shift, Contractor is to notify UK FMCE of connected equipment that was demolished. Contractor to coordinate and update UK of changes so UK FMCE may adjust the front end Building Automation System to display and alarm on only active controllers.

Please advise if Mechanical Contractor is to provide disconnection of all DDC controls interfacing with pneumatic controls from mechanical equipment scheduled for removal, and coordinate device removal with BAS to prevent nuisance alarms.

**E. CONSTRUCTION MANAGER ITEMS**

1. See attached revised Logistics plans.
2. Install ½" steel plate under scaffolding footprint being installed on side of existing building. Refer to logistics sheet attached.

End of Addendum

GRAPHIC LEGEND

- EXISTING PARTITION TO REMAIN
- EXISTING PARTITION TO BE REMOVED
- EXISTING FURNISHINGS TO BE REMOVED
- EXISTING DOOR TO REMAIN
- EXISTING DOOR AND FRAME TO BE REMOVED
- EXISTING WINDOW TO REMAIN
- EXISTING WINDOW TO BE REMOVED
- TERRAZZO TO BE REMOVED
- NON HATCHED AREAS TO HAVE FINISHES, ETC. TO REMAIN U.N.O.

GENERAL SHEET NOTES

- A. REFER TO THE PROJECT GENERAL NOTES IN THE G1.X SERIES FOR INFORMATION REGARDING VERIFICATION AND PROTECTION OF EXISTING CONDITIONS.
- B. REFER TO THE AD.X SERIES SHEETS FOR ARCHITECTURAL GENERAL NOTES, DRAWING REFERENCE AND MATERIAL SYMBOLS, ABBREVIATIONS, AS WELL AS DIMENSIONING CONVENTIONS USED ON THIS DRAWING.
- C. REFER TO AND COORDINATE WITH STRUCTURAL, CIVIL, MECHANICAL, PLUMBING, AND ELECTRICAL DRAWINGS FOR ADDITIONAL DEMOLITION INFORMATION NOT SHOWN ON THIS DRAWING.
- D. DEMOLITION WORK SHALL BE DONE IN A MANNER WHICH WILL NOT CAUSE UNNECESSARY INCONVENIENCE OR DANGER TO USERS OF THE PREMISES AND ADJACENT SITE AND NOT INTERFERE WITH ITS OPERATION. ANY DEMOLITION WORK TO BE PERFORMED MUST BE PLANNED IN ADVANCE AND APPROVED BY THE OWNER.
- E. ALL MATERIALS INDICATED TO BE REMOVED SHALL BE DISPOSED OF PROPERLY AND REMOVED FROM THE SITE UNO.
- F. ALL REMOVED MATERIALS AND EQUIPMENT WHICH IS CLASSIFIED AS "SALVAGE FOR OWNER" SHALL REMAIN THE PROPERTY OF THE OWNER. DELIVER SUCH MATERIALS AND EQUIPMENT ON THE PREMISES AS DIRECTED BY THE OWNER AND NEATLY STORE AND PROTECT FROM DAMAGE.
- G. ALL REMOVED MATERIALS AND EQUIPMENT WHICH IS CLASSIFIED "SALVAGE FOR RELOCATION" SHALL REMAIN THE PROPERTY OF THE OWNER. THE CONTRACTOR IS RESPONSIBLE FOR PLACING ITEMS IN STORAGE ON SITE AND FOR THE PROTECTION OF THOSE ITEMS. THESE ITEMS WILL BE RELOCATED. REFER TO THE FLOOR PLANS FOR NEW LOCATIONS.
- H. PATCH AND REPAIR ALL ELEMENTS THAT ARE TO REMAIN WHICH ARE DAMAGED FROM THE DEMOLITION WORK WITH CONSTRUCTION TO MATCH EXISTING CONDITIONS.
- J. REFER TO ABATEMENT DRAWING FOR COORDINATION. REFER TO ATTACHED DOCUMENTS.
- K. ALL NEW EXTERIOR OPENINGS TO BE PROTECTED AT CAVITY AREA AFTER DEMOLITION.
- L. REMOVE ALL FLOOR FINISH STRIP TRANSITIONS THROUGHOUT BUILDING U.N.O. IN FINISHED AREA TO REMAIN.

SHEET KEYNOTES

KEY VALUE	KEYNOTE TEXT
AD102	REMOVE EXISTING PLUMBING FIXTURES, TERMINATE WATER LINES AND DRAINS TO SOURCE. CAP FLOOR DRAIN LINES BELOW SLAB LEVEL AND PATCH SLAB.
AD107	DEMOLISH EXISTING STAIR IN ITS ENTIRETY.
AD115	REMOVE EXISTING DRINKING FOUNTAINS AND RETURN TO OWNER.
AD116	DEMOLISH EXISTING GLAZING SYSTEM IN ITS ENTIRETY. PREPARE FOR NEW ENCLOSURE.
AD117	DEMOLISH EXISTING HANDRAIL.
AD123	REMOVE EXISTING CEILING SYSTEM GYPSUM BOARD CEILING AND CEILING ASSOCIATED SUPPORTS GYPSUM BOARD SOFFITS WHERE APPLICABLE. REMOVE ANY EXISTING CEILING SYSTEM ABOVE THE CURRENT CEILING THROUGHOUT.
AD125	REMOVE EXISTING FIXED TABLE SYSTEM ENTIRELY THROUGHOUT.
AD126	REMOVE EXISTING CONCRETE FLOOR AND STAIRS.
AD127	REMOVE EXISTING RAISED FLOOR AND STEPS.
AD128	REMOVE EXISTING CONCRETE FLOOR SLAB / STRUCTURE AS REQUIRED FOR NEW MECHANICAL SHAFT. REFER TO STRUCTURAL.
AD130	EXISTING ELEVATOR FINISHES TO REMAIN.
AD134	REMOVE EXISTING CARVED WOOD PANELS AND SALVAGE FOR FUTURE INSTALLATION.
AD135	REMOVE EXISTING TERRAZZO FLOOR.
AD136	REMOVE EXISTING BUILT-IN BENCH AND SURROUNDING TERRAZZO.
AD137	ROOMS IN THIS AREA ARE NEWLY RENOVATED AND SHOULD ONLY BE ACCESSED AS REQUIRED FOR SELECTIVE NEW WORK.
AD138	REMOVE EXISTING FLOOR BASE AND STAIR NOSING.
AD139	GRIND TOP LAYER OF CONCRETE SLAB AS NEEDED BUT NO MORE THAN 1/2" THICKNESS. AVOID EXISTING SLAB REINFORCEMENT. DEMOLITION WORK IN PREPARATION TO RECEIVE NEW TERRAZZO FLOOR FINISH. CLOSE COORDINATION WITH STRUCTURAL DRAWINGS IS REQUIRED.
AD140	REMOVE EXISTING TIERED FLOOR ASSEMBLY AND ASSOCIATED STRUCTURE TO LIMITS SHOWN ON DRAWINGS. REFER TO STRUCTURAL FOR SHORING REQUIREMENTS.
AD142	REMOVE EXISTING PROJECTION MIRROR ASSEMBLY IN ENTIRETY.
AD143	REMOVE EXISTING WALL LADDER IN ENTIRETY.
AD144	REMOVE EXISTING FLOOR AND WALL BASE IN ENTIRETY.
AD145	REMOVE EXISTING WALL BASE IN ITS ENTIRETY.
AD147	REMOVE EXISTING FIRE EXTINGUISHER CABINET.
AD153	REMOVE EXISTING COAT RACK(S) IN ITS ENTIRETY.

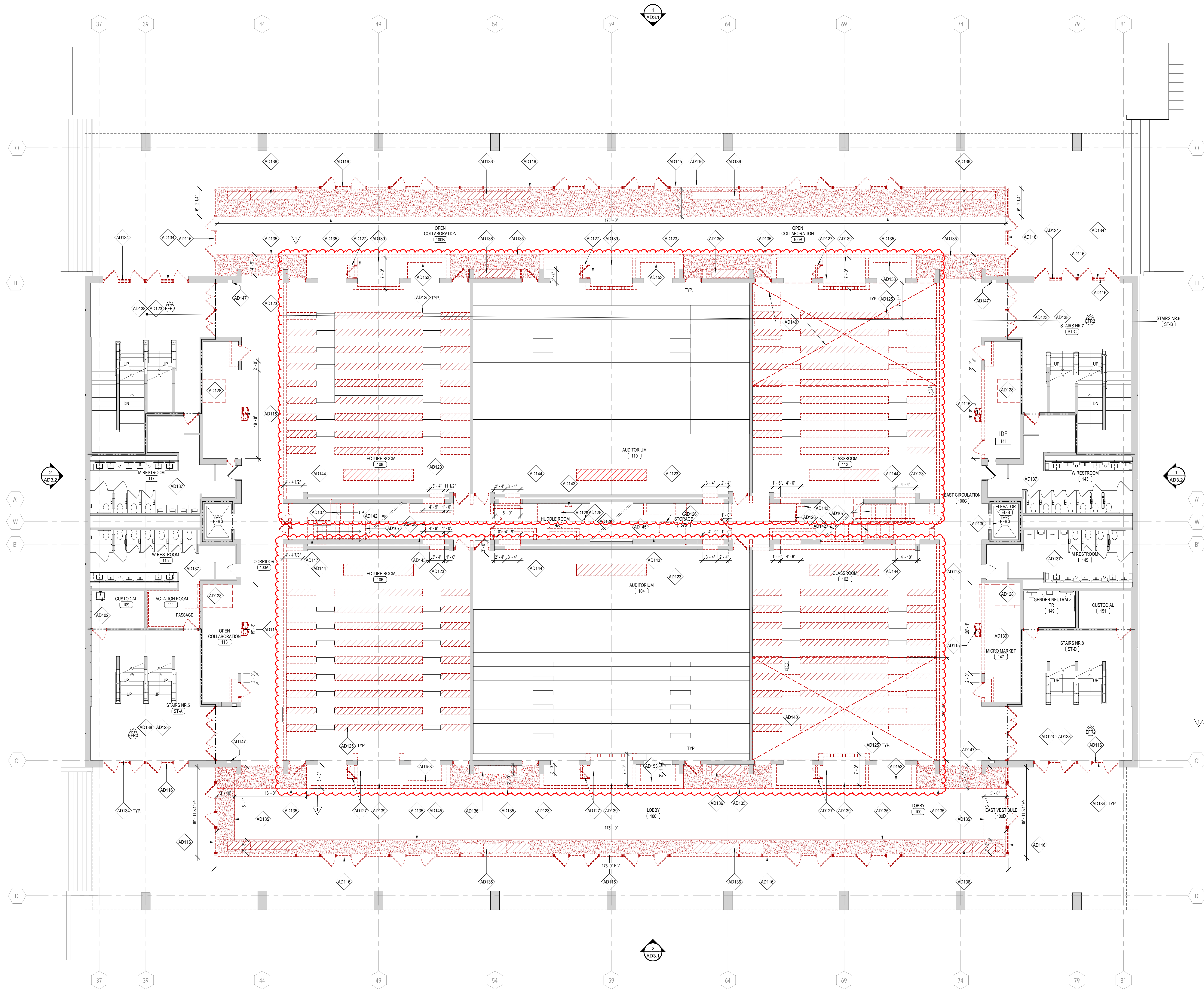

1 LEVEL 1 DEMOLITION PLAN  
1/8" = 1'-0"

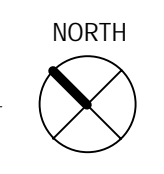

2022 UNIVERSITY OF KENTUCKY WHITE HALL RENOVATION & ADDITION  
Autodesk Docs | University of Kentucky White Hall Renovation Additio...  
6/26/2024 9:31:37 AM

Side C

Side B

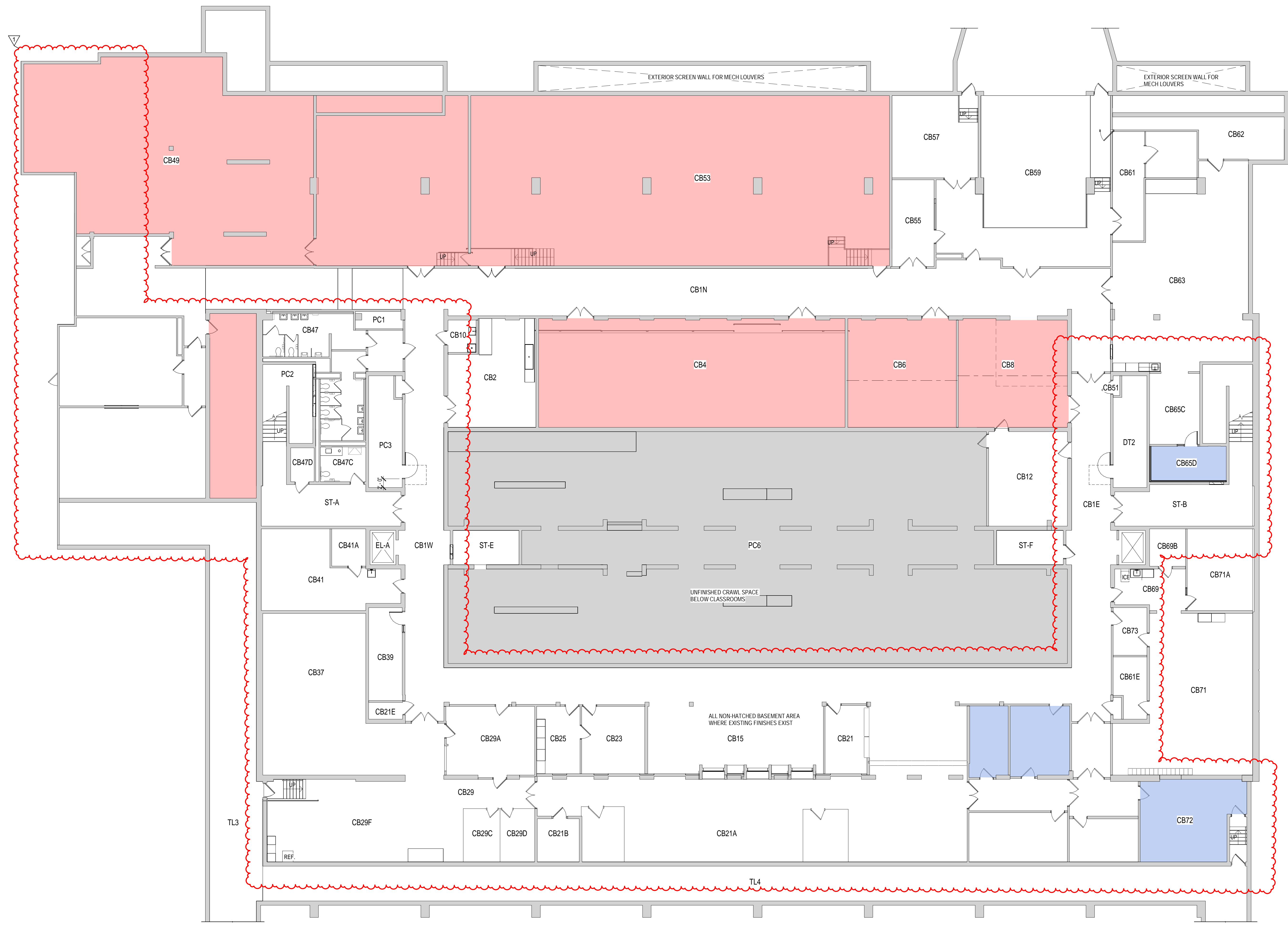

Side D



Tunnels are not included within contract scope

Side A

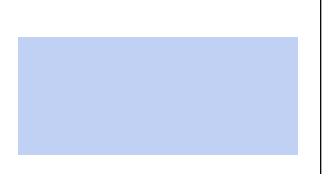
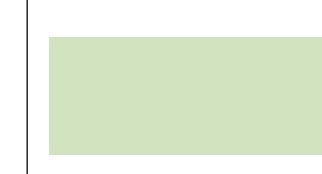
Figure 2-1

ACM VCT		Transite Panel	
ACM Glue Dots		TSI	

Basement  
UK - White Hall Classroom Building

2302 UNIVERSITY OF KENTUCKY WHITE HALL RENOVATION & ADDITION  
Autodesk Docs://University of Kentucky White Hall Renovation Additior/2302 UK WH R23.rvt  
6/26/2024 9:25:49 AM

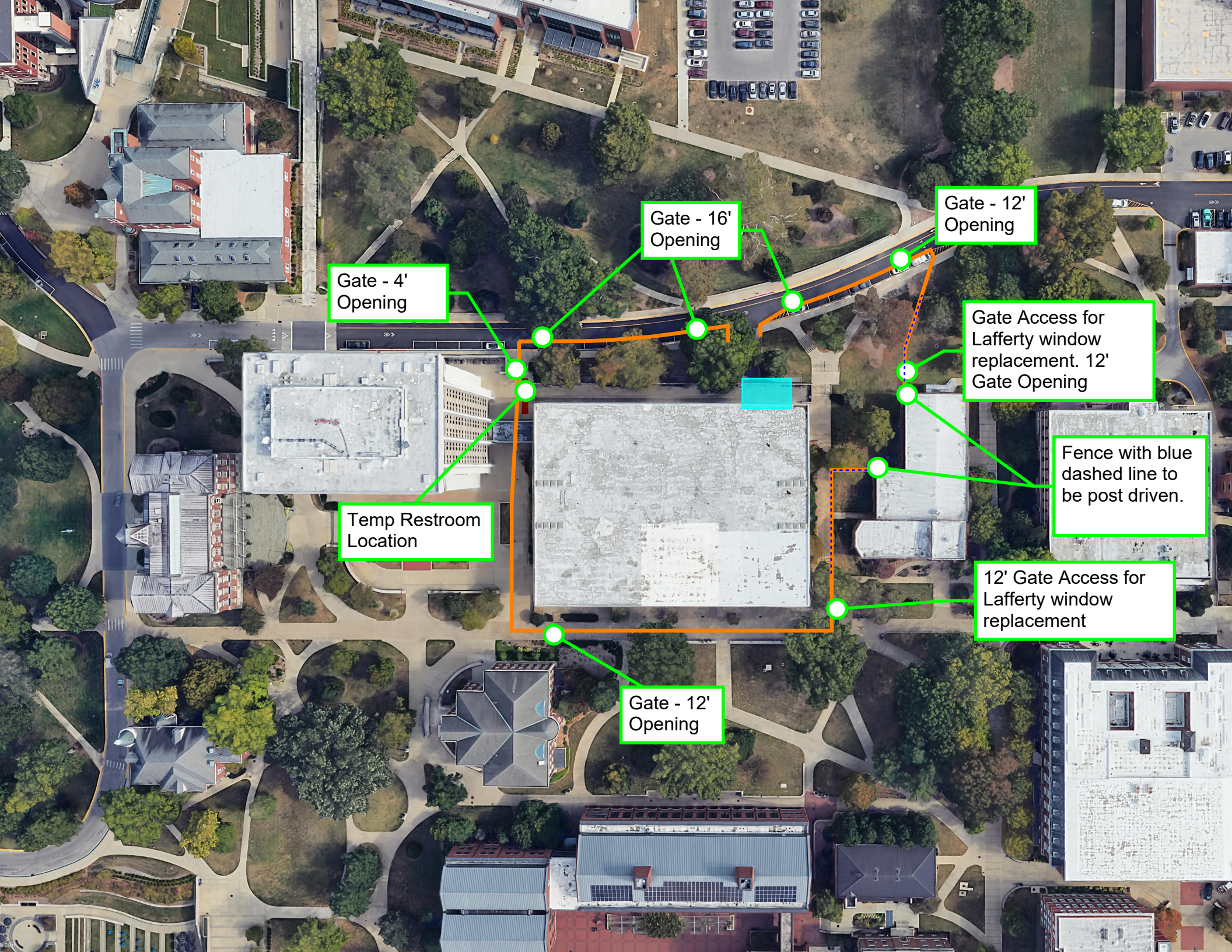

Gate - 4'  
Opening

Gate - 16'  
Opening

Gate - 12'  
Opening

Gate Access for  
Lafferty window  
replacement. 12'  
Gate Opening

Fence with blue  
dashed line to  
be post driven.

Temp Restroom  
Location

12' Gate Access for  
Lafferty window  
replacement

Gate - 12'  
Opening



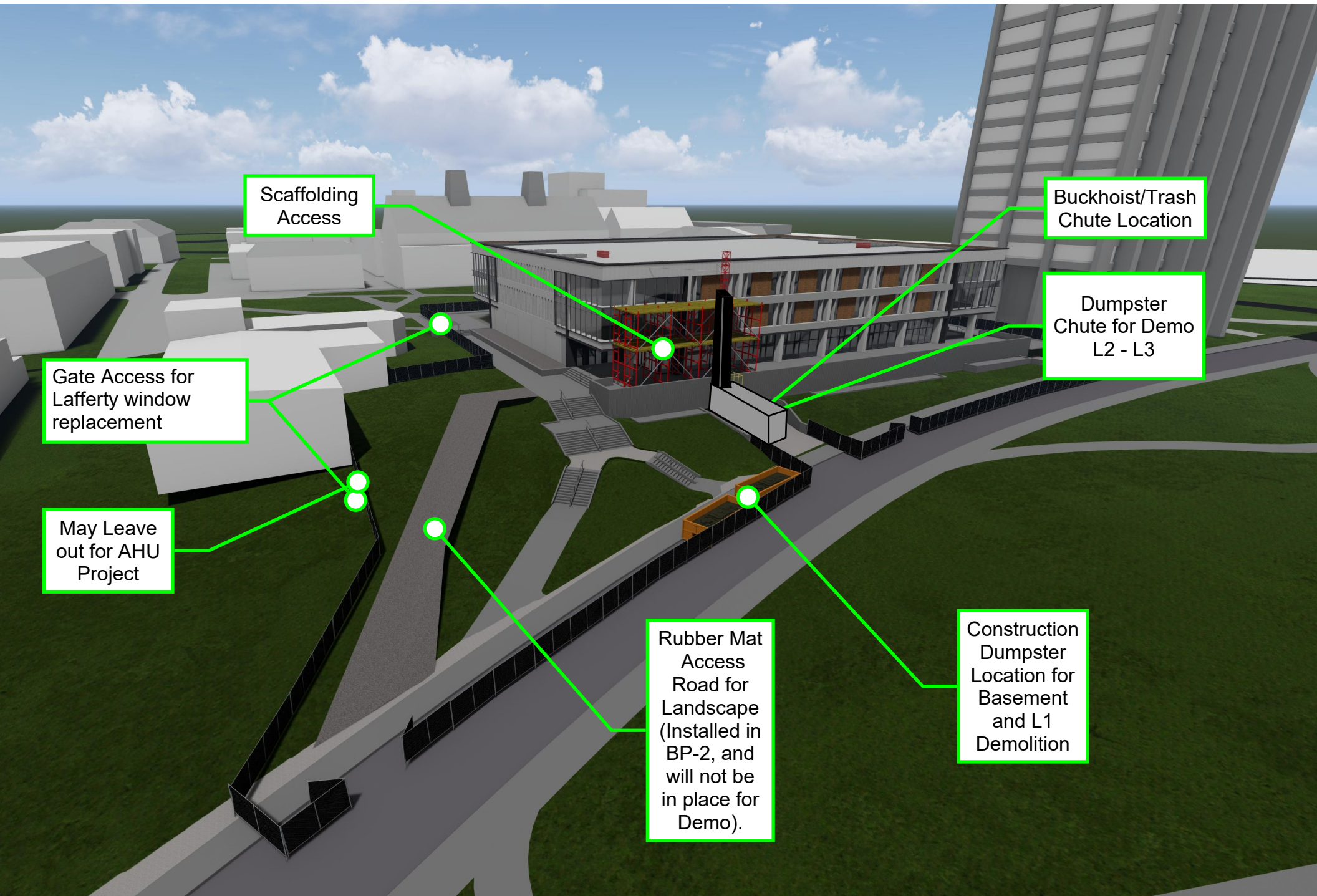

Scaffolding  
Access

Buckhoist/Trash  
Chute Location

Dumpster  
Chute for Demo  
L2 - L3

Gate Access for  
Lafferty window  
replacement

May Leave  
out for AHU  
Project

Rubber Mat  
Access  
Road for  
Landscape  
(Installed in  
BP-2, and  
will not be  
in place for  
Demo).

Construction  
Dumpster  
Location for  
Basement  
and L1  
Demolition

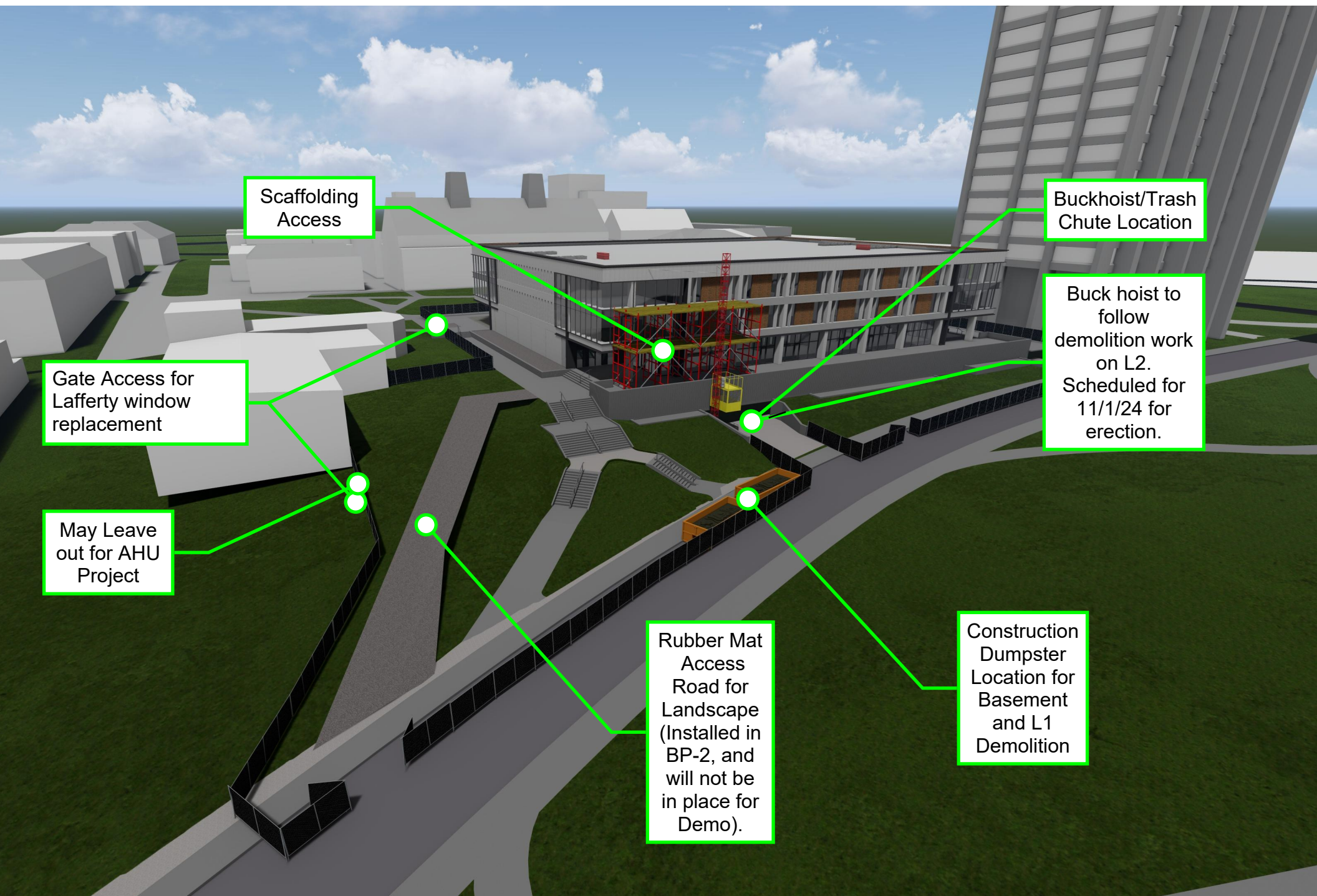

Scaffolding Access

Buckhoist/Trash Chute Location

Buck hoist to follow demolition work on L2. Scheduled for 11/1/24 for erection.

Gate Access for Lafferty window replacement

May Leave out for AHU Project

Rubber Mat Access Road for Landscape (Installed in BP-2, and will not be in place for Demo).

Construction Dumpster Location for Basement and L1 Demolition

SCOPE OF WORK BID FORM  
TP-08 Abatement, Demolition, and General Trades Combined Bid

UNIVERSITY OF KENTUCKY  
CONSTRUCTION PROCUREMENT

**FORM OF PROPOSAL**

Project No. 2590.2 Project Title: Whitehall Classroom Building Renovations - Demolition

Purchasing Officer: Corey W. Leslie

NOTE: The following Form of Proposal shall be followed exactly in submitting a proposal for this work. If this copy is lost, an additional copy will be furnished upon written request to the authority issuing Contract Documents.

This Proposal is submitted by: \_\_\_\_\_  
(NAME AND ADDRESS OF BIDDER)

Date: \_\_\_\_\_

Telephone: \_\_\_\_\_

TO: BID CLERK  
UNIVERSITY OF KENTUCKY  
CONSTRUCTION  
PROCUREMENT  
RM. 322 PETERSON SERVICE BUILDING  
LEXINGTON, KY. 40506-0005

INVITATION TO BID: CCK-2590.2-1-24  
DEADLINE: 3:00PM LEXINGTON KY TIME  
07/10/2024  
(DATE)

The Bidder, in compliance with your Invitation for Bids for the above referenced Project, having carefully examined the site of the Work, the Drawings and complete Contract Documents as defined in Article I of the General Conditions, as well as the Specifications affecting the work as prepared by the Consultant, hereby proposes to furnish all labor, materials, supplies and services required to construct the Project in accordance with the Contract Documents, within the time set forth therein, and at the price stated below without qualification.

The Bidder hereby acknowledges receipt of the following Addenda:

- ADDENDUM NO. \_\_\_\_\_ DATED \_\_\_\_\_
- ADDENDUM NO. \_\_\_\_\_ DATED \_\_\_\_\_
- ADDENDUM NO. \_\_\_\_\_ DATED \_\_\_\_\_
- ADDENDUM NO. \_\_\_\_\_ DATED \_\_\_\_\_
- ADDENDUM NO. \_\_\_\_\_ DATED \_\_\_\_\_
- ADDENDUM NO. \_\_\_\_\_ DATED \_\_\_\_\_

(Here insert the number and date of any Addenda issued and received. If none has been issued and received, the word NONE should be inserted.)

Contractor Report of Prior Violations of  
Chapters 136,139, 141, 337, 338, 341, and 342

Pursuant to KRS 45A.485, the Contractor shall, prior to the award of a Contract, reveal final determinations of any violations of the provisions of KRS Chapters 136, 139, 141, 337, 338, 341, and 342 by the Contractor that have occurred in the previous five (5) year period.

This statute also requires for the duration of the Contract established, the Contractor be in continuous compliance with the provisions of Chapters 136, 139, 141, 337, 338, 341, and 342 that apply to the Contractor’s operations. The Contractor’s failure to reveal a final determination of a violation of KRS Chapters 136, 139, 141, 337, 338, 341, and 342, or failure to comply with any of the above cited statutes for the duration of the Contract shall be grounds for the cancellation of the Contract, and the disqualification from eligibility for future contracts for a period of two (2) years.

The Contractor, by signing and submitting a Bid on this Invitation, agrees as required by KRS 45A.485 to submit final determinations of any violations of the provisions of KRS Chapters 136, 139, 141, 337, 338, 341, and 342 that have occurred in the previous five (5) years prior to the award of a Contract and agrees to remain in continuous compliance with the provisions of these statutes during the duration of any contract that may be established. Final determinations of any violations of these statutes, must be provided to the University by the successful Contractor prior to the award of a Contract.

LUMP SUM PROPOSAL

The Bidder agrees to furnish all labor, materials, supplies and services required to complete the Work, for the above referenced Project, for the Capital Construction Procurement Section, University of Kentucky, as described in the Specifications and Contract Documents and shown on the Drawings enumerated below and as modified by the Addenda listed above.

FOR THE LUMP SUM OF \_\_\_\_\_  
(USE WORDS)  
\_\_\_\_\_ DOLLARS AND \_\_\_\_\_ CENTS.  
(USE WORDS) (USE WORDS)  
(\$ \_\_\_\_\_)  
(USE FIGURES)

**004100B01**

**FORM OF PROPOSAL**

**AUTHENTICATION OF BID AND STATEMENT OF NON-COLLUSION AND NON-CONFLICT OF INTEREST**

I hereby certify:

1. That I am the Bidder (if the Bidder is an individual), a partner in the Bidder (if the Bidder is a partnership), or an officer or employee of the bidding corporation having authority to sign on its behalf (if the Bidder is a corporation);
2. That the submitted Bid or Bids covering Capital Construction Procurement Section Invitation No. CCK-2590.2-1-24 have been arrived at by the Bidder independently and have been submitted without collusion with, and without any agreement, understanding or planned common course of action with, any other contractor, vendor of materials, supplies, equipment or services described in the Invitation to Bid, designed to limit independent bidding or competition; as prohibited by provision KRS 45A.325;
3. That the contents of the Bid or Bids have not been communicated by the Bidder or its employees or agents to any person not an employee or agent of the Bidder or its surety on any bond furnished with the Bid or Bids and will not be communicated to any such person prior to the official opening of the Bid or Bids;
4. That the Bidder is legally entitled to enter into the contracts with the University of Kentucky and is not in violation of any prohibited conflict of interest, including those prohibited by the provisions of KRS 164.390, and 45A.330 to 45A.340 and 45A.455;
5. This offer is good for 60 calendar days from the date this Bid is opened. In submitting the above, it is expressly agreed that upon proper acceptance by the Capital Construction Procurement Section of any or all items Bid above, a contract shall thereby be created with respect to the items accepted;
6. That I have fully informed myself regarding and affirm the accuracy of all statements made in this Form of Proposal including Bid Amount.
7. Unless otherwise exempted by KRS 45.590, the Bidder intends to comply in full with all requirements of the Kentucky Civil Rights Act and to submit data required by the Kentucky Equal Employment Act upon being designated the successful contractor.
8. That the bidding contractor and all subcontractors to be employed do not and will not maintain any facilities they provide for employees in a segregated manner and they are in full compliance with provisions of 41 CFR 60-1.8 that prohibits the maintaining of segregated facilities.
9. In accordance with KRS45A.110(2), the undersigned hereby swears under penalty of perjury that he/she has not knowingly violated any provision of the campaign finance laws of the Commonwealth of Kentucky and that the award of a contract to the bidder will not violate any provision of the campaign finance laws of the Commonwealth of Kentucky.

**READ CAREFULLY - SIGN IN SPACE BELOW - FAILURE TO SIGN INVALIDATES BID**

SIGNED BY \_\_\_\_\_ TITLE \_\_\_\_\_

PRINT NAME \_\_\_\_\_ FIRM \_\_\_\_\_

ADDRESS \_\_\_\_\_ AREA CODE & PHONE \_\_\_\_\_

\_\_\_\_\_ FAX \_\_\_\_\_

CITY \_\_\_\_\_ STATE \_\_\_\_\_ ZIP CODE \_\_\_\_\_

BIDDER'S EMAIL \_\_\_\_\_ DATE \_\_\_\_\_

**BUSINESS CLASSIFICATION**

Please complete this form which is necessary for the University of Kentucky vendor database. Mark only one classification. Refer to "Definitions" for assistance in determining correct classification.

- |                                      |  |
|--------------------------------------|--|
| (01)___ Small Business               | (06)___ Woman-Owned Large Business               |
| (02)___ Large Business               | (07)___ Disadvantaged Woman-Owned Small Business |
| (03)___ Disadvantaged Small Business | (08)___ Disadvantaged Woman-Owned Large Business |
| (04)___ Disadvantaged Large Business | (09)___ Other                                    |
| (05)___ Woman-Owned Small Business   |  |

**DEFINITIONS**

- (01) **SMALL BUSINESS:** A business concern that is organized for profit, is independently owned and operated, is not dominant in the field of operations in which it is bidding, and meets the size standards as prescribed in the Code of Federal Regulations, Title 13, Part 121. Consult your local or district Small Business Administration (SBA) office if further clarification is needed.
- (02) **LARGE BUSINESS:** A business concern that exceeds the small business size code standards established by SBA.
- (03) **DISADVANTAGED SMALL BUSINESS:** A business concern (a) that is at least 51 percent owned by one or more socially and economically disadvantaged individuals (as defined below), or a publicly owned business, having at least 51 percent of its stock owned by one or more socially and economically disadvantaged individuals; and (b) has its management and daily business operations controlled by one or more such individuals. Socially and economically disadvantaged individuals include: Asian, Black/African American, Hispanic or Latino, Native American, Native Hawaiian/Pacific Islander, Women, Disabled, Veteran and Disabled Veteran and other minorities or individuals found to be disadvantaged by the SBA.
- (04) **DISADVANTAGED LARGE BUSINESS:** A concern that meets the definition of socially and economically disadvantaged individuals as defined above, but which is not a small business by the SBA's size standards.
- (05) **WOMAN-OWNED SMALL BUSINESS:** A small business that is at least 51 percent owned by a woman or women who also control and operate it. "Control" in this context means exercising the power to make policy decisions. "Operate" means actively involved in the day to day management.
- (06) **WOMAN-OWNED LARGE BUSINESS:** A concern that meets the definition of woman owned and operated, but which is not a small business by the SBA's standards.
- (07) **DISADVANTAGED, WOMAN-OWNED SMALL BUSINESS:** A concern that meets the definition of both (03) and (05) above.
- (08) **DISADVANTAGED, WOMAN OWNED LARGE BUSINESS:** A concern that meets the definition of both (04) and (06) above.
- (09) **OTHER:** A concern that does not meet any of the above definitions.

**004100B01**

THE FOLLOWING ITEMS ARE HEREWITH ENCLOSED AS REQUIRED BY KRS 45A.185

1. Bid Bond or Certified Check in an amount not less than five percent (5%) of total Bid.
2. List of Proposed Subcontractors and Unit Prices. (if required)
3. Authentication of Bid and Statement of Non-Collusion and Non-Conflict of Interest.
4. List of Materials and Equipment.
5. **VENDOR NUMBER:** It is imperative that you furnish your Federal Employer Identification Number in the space provided below. Failure to do so may delay the processing of purchase orders issued to your firm.

---

(Nine Digit Number)

**BIDDER'S QUALIFICATIONS**

The Commonwealth of Kentucky Model Procurement Code (KRS 45A.080) requires contracts to be awarded, "to the responsive and responsible bidder whose bid offers the best value" to the University of Kentucky. In order to determine if the Bidder has the experience, qualifications, resources and necessary attributes to provide the quality workmanship, materials and management required by the plans and specifications, the Bidder may be required to complete and submit the information requested on the University of Kentucky Contractor Bidder Determination of Responsibility questionnaire. Failure to provide the information requested on the questionnaire or failure to provide any additional submittals or information that may be requested to make this determination may be grounds for a declaration of non-responsibility with respect to the Bidder. A copy of the Contractor Determination of Responsibility questionnaire is available upon request to all Bidders.

**TIME LIMIT FOR EXECUTION OF CONTRACT DOCUMENTS**

It is further agreed, that in the event this Proposal is accepted by the Owner and the undersigned shall fail to execute the Contract and furnish satisfactory Payment and Performance Bond within ten (10) consecutive calendar days from the date of notification of the award of the Contract, the Owner may at his option, determine that the undersigned has abandoned the Contract and thereupon, the Proposal shall become null and void and the Bid guarantee, check or Bid bond which accompanied it shall be forfeited and become the property of the Owner as liquidated damages for each failure and no protest pursuant to such action will be made. If the Undersigned shall execute the Contract, and furnish satisfactory Payment Bond and Performance Bond, it is understood that the Bid Guarantee or Bid Bond will be returned to the undersigned by the Owner.

UNIT PRICES

NOTE: Unit Prices shall include the furnishing of all labor, materials, supplies and services and shall include all items of cost, overhead and profit for the Contractor and any subcontractor involved, and shall be used uniformly without modifications for either additions or deductions. The Unit Prices as established shall be used to determine the equitable adjustment of the Contract Price in connection with changes, deletions or extra work performed under the Contract and the "Rules of Measurement" set forth in the General Conditions shall govern.

*All Bidders will be required to complete and submit the following Unit Prices with the bid.*

*The apparent low bidder is requested to attend a post bid meeting which will be scheduled at a later date.*

DESCRIPTION OF WORK	U/M	UNIT PRICE
Performance & Payment Bond	Contract Value	_____



**BIDDER'S PROPOSED MAJOR SUBCONTRACTORS AND SUPPLIERS**

**\*\*\*DUE BY BID DEADLINE\*\*\***

For the purposes of this form, a major subcontractor or supplier is a person or entity that will have a direct or assigned contract or purchase order for the performance or supply of any item listed below if the bidder is successful.

All subcontractors must comply with the laws of the Commonwealth of Kentucky and the policies and procedures of the University of Kentucky as administrated by the UK Capital Construction Procurement Section and Capital Project Management Division.

If the bidder will self-perform these items, list "Self-Perform" for each applicable item.

No major subcontractor or supplier may be added or changed without written consent of the Owner's representative after the bid deadline.

**The apparent low bidder may be required to attend a post bid review meeting which will be scheduled at a later date.**

DIVISION OF WORK

NAME AND ADDRESS OF SUBCONTRACTOR

Shoring

\_\_\_\_\_

Engineering

\_\_\_\_\_

Saw Cutting

\_\_\_\_\_

Scaffolding

\_\_\_\_\_

Buck hoist

\_\_\_\_\_

Fencing

\_\_\_\_\_

\_\_\_\_\_

\_\_\_\_\_

\_\_\_\_\_

\_\_\_\_\_

\_\_\_\_\_

\_\_\_\_\_

\_\_\_\_\_

\_\_\_\_\_

LIST OF MATERIALS AND EQUIPMENT

Each item listed under the different phases of construction must be clearly identified so that the Owner will definitely know what the Bidder proposes to furnish.

The use of a manufacturer's or dealer's name only, or stating "as per Plans and Specifications," will not be considered as sufficient identification.

Where more than one "Make" or "Brand" is listed for any one item, the Owner has the right to select the one to be used.

**The apparent low bidders will be required to complete and submit to the University the following information by twelve o'clock (12) noon of the first working day following the bid opening. The information requested in this submittal is required to assist the University in determining contractor responsibility to complete the project being bid.**

**The apparent low bidder may be required to attend a post bid review meeting which will be scheduled at a later date.**

ITEM	MATERIALS AND EQUIPMENT	BRAND OR MANUFACTURER
Fencing		_____
Floor Protection		_____
		_____
		_____
		_____
		_____
		_____
		_____
		_____
		_____
		_____
		_____
		_____
		_____

BIDDER ECONOMIC INCLUSION EFFORTS

The University of Kentucky is committed to serving as an advocate for diverse businesses and Kentucky located businesses. Diverse Business Enterprises (DBE) consist of minority, women, disabled, veteran, and disabled veteran owned business firms that are at least fifty-one percent owned and operated by an individual(s) of the aforementioned categories. Also included in this category are disabled business enterprises and non-profit work centers for the blind and severely disabled. To be deemed a Kentucky located Business a company must have a physical facility located in the Commonwealth of Kentucky that is engaged in on-going business operations.

The University is committed to increasing the amount of goods and services acquired from businesses owned and controlled by diverse persons to 10% of all procurement expenditures. The University expects its suppliers to support and assist in this effort. The University is also dedicated to increasing the amount of goods and services acquired from Kentucky located companies to the greatest extent possible in support of our economic development efforts.

If the total dollar amount of these contracts does not meet the University’s goals for DBE and local businesses, you must provide documentation of your good faith efforts as part of your Determination of Responsibility submittal.

- 1. DBE (Ethnic or Woman) Subcontractors

---

---

---

- 2. DBE (Ethnic or Woman) Material Suppliers

---

---

---

- 3. Kentucky Located Subcontractors

---

---

---

- 4. Kentucky Located Materials Suppliers

---

---

---

SCOPE OF WORK BID FORM  
TP-09 Demolition and General Trades Combined Bid

UNIVERSITY OF KENTUCKY  
CONSTRUCTION PROCUREMENT

**FORM OF PROPOSAL**

Project No. 2590.2 Project Title: Whitehall Classroom Building Renovations - Demolition

Purchasing Officer: Corey W. Leslie

NOTE: The following Form of Proposal shall be followed exactly in submitting a proposal for this work. If this copy is lost, an additional copy will be furnished upon written request to the authority issuing Contract Documents.

This Proposal is submitted by: \_\_\_\_\_  
(NAME AND ADDRESS OF BIDDER)

Date: \_\_\_\_\_

Telephone: \_\_\_\_\_

TO: BID CLERK  
UNIVERSITY OF KENTUCKY  
CONSTRUCTION  
PROCUREMENT  
RM. 322 PETERSON SERVICE BUILDING  
LEXINGTON, KY. 40506-0005

INVITATION TO BID: CCK-2590.2-1-24  
DEADLINE: 3:00PM LEXINGTON KY TIME  
07/10/2024  
(DATE)

The Bidder, in compliance with your Invitation for Bids for the above referenced Project, having carefully examined the site of the Work, the Drawings and complete Contract Documents as defined in Article I of the General Conditions, as well as the Specifications affecting the work as prepared by the Consultant, hereby proposes to furnish all labor, materials, supplies and services required to construct the Project in accordance with the Contract Documents, within the time set forth therein, and at the price stated below without qualification.

The Bidder hereby acknowledges receipt of the following Addenda:

- ADDENDUM NO. \_\_\_\_\_ DATED \_\_\_\_\_
- ADDENDUM NO. \_\_\_\_\_ DATED \_\_\_\_\_
- ADDENDUM NO. \_\_\_\_\_ DATED \_\_\_\_\_
- ADDENDUM NO. \_\_\_\_\_ DATED \_\_\_\_\_
- ADDENDUM NO. \_\_\_\_\_ DATED \_\_\_\_\_
- ADDENDUM NO. \_\_\_\_\_ DATED \_\_\_\_\_

(Here insert the number and date of any Addenda issued and received. If none has been issued and received, the word NONE should be inserted.)

Contractor Report of Prior Violations of  
Chapters 136,139, 141, 337, 338, 341, and 342

Pursuant to KRS 45A.485, the Contractor shall, prior to the award of a Contract, reveal final determinations of any violations of the provisions of KRS Chapters 136, 139, 141, 337, 338, 341, and 342 by the Contractor that have occurred in the previous five (5) year period.

This statute also requires for the duration of the Contract established, the Contractor be in continuous compliance with the provisions of Chapters 136, 139, 141, 337, 338, 341, and 342 that apply to the Contractor’s operations. The Contractor’s failure to reveal a final determination of a violation of KRS Chapters 136, 139, 141, 337, 338, 341, and 342, or failure to comply with any of the above cited statutes for the duration of the Contract shall be grounds for the cancellation of the Contract, and the disqualification from eligibility for future contracts for a period of two (2) years.

The Contractor, by signing and submitting a Bid on this Invitation, agrees as required by KRS 45A.485 to submit final determinations of any violations of the provisions of KRS Chapters 136, 139, 141, 337, 338, 341, and 342 that have occurred in the previous five (5) years prior to the award of a Contract and agrees to remain in continuous compliance with the provisions of these statutes during the duration of any contract that may be established. Final determinations of any violations of these statutes, must be provided to the University by the successful Contractor prior to the award of a Contract.

LUMP SUM PROPOSAL

The Bidder agrees to furnish all labor, materials, supplies and services required to complete the Work, for the above referenced Project, for the Capital Construction Procurement Section, University of Kentucky, as described in the Specifications and Contract Documents and shown on the Drawings enumerated below and as modified by the Addenda listed above.

FOR THE LUMP SUM OF \_\_\_\_\_  
(USE WORDS)  
\_\_\_\_\_ DOLLARS AND \_\_\_\_\_ CENTS.  
(USE WORDS) (USE WORDS)  
(\$ \_\_\_\_\_)  
(USE FIGURES)

**004100B01**

**FORM OF PROPOSAL**

**AUTHENTICATION OF BID AND STATEMENT OF NON-COLLUSION AND NON-CONFLICT OF INTEREST**

I hereby certify:

1. That I am the Bidder (if the Bidder is an individual), a partner in the Bidder (if the Bidder is a partnership), or an officer or employee of the bidding corporation having authority to sign on its behalf (if the Bidder is a corporation);
2. That the submitted Bid or Bids covering Capital Construction Procurement Section Invitation No. CCK-2590.2-1-24 have been arrived at by the Bidder independently and have been submitted without collusion with, and without any agreement, understanding or planned common course of action with, any other contractor, vendor of materials, supplies, equipment or services described in the Invitation to Bid, designed to limit independent bidding or competition; as prohibited by provision KRS 45A.325;
3. That the contents of the Bid or Bids have not been communicated by the Bidder or its employees or agents to any person not an employee or agent of the Bidder or its surety on any bond furnished with the Bid or Bids and will not be communicated to any such person prior to the official opening of the Bid or Bids;
4. That the Bidder is legally entitled to enter into the contracts with the University of Kentucky and is not in violation of any prohibited conflict of interest, including those prohibited by the provisions of KRS 164.390, and 45A.330 to 45A.340 and 45A.455;
5. This offer is good for 60 calendar days from the date this Bid is opened. In submitting the above, it is expressly agreed that upon proper acceptance by the Capital Construction Procurement Section of any or all items Bid above, a contract shall thereby be created with respect to the items accepted;
6. That I have fully informed myself regarding and affirm the accuracy of all statements made in this Form of Proposal including Bid Amount.
7. Unless otherwise exempted by KRS 45.590, the Bidder intends to comply in full with all requirements of the Kentucky Civil Rights Act and to submit data required by the Kentucky Equal Employment Act upon being designated the successful contractor.
8. That the bidding contractor and all subcontractors to be employed do not and will not maintain any facilities they provide for employees in a segregated manner and they are in full compliance with provisions of 41 CFR 60-1.8 that prohibits the maintaining of segregated facilities.
9. In accordance with KRS45A.110(2), the undersigned hereby swears under penalty of perjury that he/she has not knowingly violated any provision of the campaign finance laws of the Commonwealth of Kentucky and that the award of a contract to the bidder will not violate any provision of the campaign finance laws of the Commonwealth of Kentucky.

**READ CAREFULLY - SIGN IN SPACE BELOW - FAILURE TO SIGN INVALIDATES BID**

SIGNED BY \_\_\_\_\_ TITLE \_\_\_\_\_

PRINT NAME \_\_\_\_\_ FIRM \_\_\_\_\_

ADDRESS \_\_\_\_\_ AREA CODE & PHONE \_\_\_\_\_

\_\_\_\_\_ FAX \_\_\_\_\_

CITY \_\_\_\_\_ STATE \_\_\_\_\_ ZIP CODE \_\_\_\_\_

BIDDER'S EMAIL \_\_\_\_\_ DATE \_\_\_\_\_

## BUSINESS CLASSIFICATION

Please complete this form which is necessary for the University of Kentucky vendor database.  
Mark only one classification. Refer to "Definitions" for assistance in determining correct classification.

- |                                      |  |
|--------------------------------------|--|
| (01)___ Small Business               | (06)___ Woman-Owned Large Business               |
| (02)___ Large Business               | (07)___ Disadvantaged Woman-Owned Small Business |
| (03)___ Disadvantaged Small Business | (08)___ Disadvantaged Woman-Owned Large Business |
| (04)___ Disadvantaged Large Business | (09)___ Other                                    |
| (05)___ Woman-Owned Small Business   |  |

**DEFINITIONS**

- (01) **SMALL BUSINESS:** A business concern that is organized for profit, is independently owned and operated, is not dominant in the field of operations in which it is bidding, and meets the size standards as prescribed in the Code of Federal Regulations, Title 13, Part 121. Consult your local or district Small Business Administration (SBA) office if further clarification is needed.
- (02) **LARGE BUSINESS:** A business concern that exceeds the small business size code standards established by SBA.
- (03) **DISADVANTAGED SMALL BUSINESS:** A business concern (a) that is at least 51 percent owned by one or more socially and economically disadvantaged individuals (as defined below), or a publicly owned business, having at least 51 percent of its stock owned by one or more socially and economically disadvantaged individuals; and (b) has its management and daily business operations controlled by one or more such individuals. Socially and economically disadvantaged individuals include: Asian, Black/African American, Hispanic or Latino, Native American, Native Hawaiian/Pacific Islander, Women, Disabled, Veteran and Disabled Veteran and other minorities or individuals found to be disadvantaged by the SBA.
- (04) **DISADVANTAGED LARGE BUSINESS:** A concern that meets the definition of socially and economically disadvantaged individuals as defined above, but which is not a small business by the SBA's size standards.
- (05) **WOMAN-OWNED SMALL BUSINESS:** A small business that is at least 51 percent owned by a woman or women who also control and operate it. "Control" in this context means exercising the power to make policy decisions. "Operate" means actively involved in the day to day management.
- (06) **WOMAN-OWNED LARGE BUSINESS:** A concern that meets the definition of woman owned and operated, but which is not a small business by the SBA's standards.
- (07) **DISADVANTAGED, WOMAN-OWNED SMALL BUSINESS:** A concern that meets the definition of both (03) and (05) above.
- (08) **DISADVANTAGED, WOMAN OWNED LARGE BUSINESS:** A concern that meets the definition of both (04) and (06) above.
- (09) **OTHER:** A concern that does not meet any of the above definitions.

**004100B01**

THE FOLLOWING ITEMS ARE HEREWITH ENCLOSED AS REQUIRED BY KRS 45A.185

1. Bid Bond or Certified Check in an amount not less than five percent (5%) of total Bid.
2. List of Proposed Subcontractors and Unit Prices. (if required)
3. Authentication of Bid and Statement of Non-Collusion and Non-Conflict of Interest.
4. List of Materials and Equipment.
5. **VENDOR NUMBER:** It is imperative that you furnish your Federal Employer Identification Number in the space provided below. Failure to do so may delay the processing of purchase orders issued to your firm.

---

(Nine Digit Number)

**BIDDER'S QUALIFICATIONS**

The Commonwealth of Kentucky Model Procurement Code (KRS 45A.080) requires contracts to be awarded, "to the responsive and responsible bidder whose bid offers the best value" to the University of Kentucky. In order to determine if the Bidder has the experience, qualifications, resources and necessary attributes to provide the quality workmanship, materials and management required by the plans and specifications, the Bidder may be required to complete and submit the information requested on the University of Kentucky Contractor Bidder Determination of Responsibility questionnaire. Failure to provide the information requested on the questionnaire or failure to provide any additional submittals or information that may be requested to make this determination may be grounds for a declaration of non-responsibility with respect to the Bidder. A copy of the Contractor Determination of Responsibility questionnaire is available upon request to all Bidders.

**TIME LIMIT FOR EXECUTION OF CONTRACT DOCUMENTS**

It is further agreed, that in the event this Proposal is accepted by the Owner and the undersigned shall fail to execute the Contract and furnish satisfactory Payment and Performance Bond within ten (10) consecutive calendar days from the date of notification of the award of the Contract, the Owner may at his option, determine that the undersigned has abandoned the Contract and thereupon, the Proposal shall become null and void and the Bid guarantee, check or Bid bond which accompanied it shall be forfeited and become the property of the Owner as liquidated damages for each failure and no protest pursuant to such action will be made. If the Undersigned shall execute the Contract, and furnish satisfactory Payment Bond and Performance Bond, it is understood that the Bid Guarantee or Bid Bond will be returned to the undersigned by the Owner.



UNIT PRICES

NOTE: Unit Prices shall include the furnishing of all labor, materials, supplies and services and shall include all items of cost, overhead and profit for the Contractor and any subcontractor involved, and shall be used uniformly without modifications for either additions or deductions. The Unit Prices as established shall be used to determine the equitable adjustment of the Contract Price in connection with changes, deletions or extra work performed under the Contract and the "Rules of Measurement" set forth in the General Conditions shall govern.

*All Bidders will be required to complete and submit the following Unit Prices with the bid.*

*The apparent low bidder is requested to attend a post bid meeting which will be scheduled at a later date.*

DESCRIPTION OF WORK	U/M	UNIT PRICE
Performance & Payment Bond	Contract Value	_____

BIDDER'S PROPOSED MAJOR SUBCONTRACTORS AND SUPPLIERS

\*\*\*DUE BY BID DEADLINE\*\*\*

For the purposes of this form, a major subcontractor or supplier is a person or entity that will have a direct or assigned contract or purchase order for the performance or supply of any item listed below if the bidder is successful.

All subcontractors must comply with the laws of the Commonwealth of Kentucky and the policies and procedures of the University of Kentucky as administrated by the UK Capital Construction Procurement Section and Capital Project Management Division.

If the bidder will self-perform these items, list "Self-Perform" for each applicable item.

No major subcontractor or supplier may be added or changed without written consent of the Owner's representative after the bid deadline.

The apparent low bidder may be required to attend a post bid review meeting which will be scheduled at a later date.

DIVISION OF WORK

NAME AND ADDRESS OF SUBCONTRACTOR

Shoring

\_\_\_\_\_

Engineering

\_\_\_\_\_

Saw Cutting

\_\_\_\_\_

Scaffolding

\_\_\_\_\_

Buck hoist

\_\_\_\_\_

Fencing

\_\_\_\_\_

\_\_\_\_\_

\_\_\_\_\_

\_\_\_\_\_

\_\_\_\_\_

\_\_\_\_\_

\_\_\_\_\_

\_\_\_\_\_

\_\_\_\_\_

LIST OF MATERIALS AND EQUIPMENT

Each item listed under the different phases of construction must be clearly identified so that the Owner will definitely know what the Bidder proposes to furnish.

The use of a manufacturer's or dealer's name only, or stating "as per Plans and Specifications," will not be considered as sufficient identification.

Where more than one "Make" or "Brand" is listed for any one item, the Owner has the right to select the one to be used.

**The apparent low bidders will be required to complete and submit to the University the following information by twelve o'clock (12) noon of the first working day following the bid opening. The information requested in this submittal is required to assist the University in determining contractor responsibility to complete the project being bid.**

**The apparent low bidder may be required to attend a post bid review meeting which will be scheduled at a later date.**

ITEM	MATERIALS AND EQUIPMENT	BRAND OR MANUFACTURER
Fencing		_____
Floor Protection		_____
		_____
		_____
		_____
		_____
		_____
		_____
		_____
		_____
		_____
		_____
		_____
		_____

BIDDER ECONOMIC INCLUSION EFFORTS

The University of Kentucky is committed to serving as an advocate for diverse businesses and Kentucky located businesses. Diverse Business Enterprises (DBE) consist of minority, women, disabled, veteran, and disabled veteran owned business firms that are at least fifty-one percent owned and operated by an individual(s) of the aforementioned categories. Also included in this category are disabled business enterprises and non-profit work centers for the blind and severely disabled. To be deemed a Kentucky located Business a company must have a physical facility located in the Commonwealth of Kentucky that is engaged in on-going business operations.

The University is committed to increasing the amount of goods and services acquired from businesses owned and controlled by diverse persons to 10% of all procurement expenditures. The University expects its suppliers to support and assist in this effort. The University is also dedicated to increasing the amount of goods and services acquired from Kentucky located companies to the greatest extent possible in support of our economic development efforts.

If the total dollar amount of these contracts does not meet the University’s goals for DBE and local businesses, you must provide documentation of your good faith efforts as part of your Determination of Responsibility submittal.

- 1. DBE (Ethnic or Woman) Subcontractors

---

---

---

- 2. DBE (Ethnic or Woman) Material Suppliers

---

---

---

- 3. Kentucky Located Subcontractors

---

---

---

- 4. Kentucky Located Materials Suppliers

---

---

---