

COILS INSTALLATION PACKAGE 3

Medical Science	# Coils	Room #	Projected ship date	Projected Installation Schedule	Weight	Crate Dimensions	Note
AHU 2	2	PH 701	6/6/2023	June 26 - June 30	3280	10x5x4	1 crate 2 coils
AHU 3	2	PH 701	6/6/2023	July 3 - July 7	4353	12x5x4.5	1 crate 2 coils
AHU 4	2	PH 701	6/6/2023	July 10 - July 14	4353	12x5x4.5	1 crate 2 coils
AHU 5	2	PH 701	6/6/2023	July 17 - July 21	3280	10x5x4	1 crate 2 coils
AHU 6	2	PH 703	6/15/2023	July 24 - July 28	2970	10x5x4	1 crate 2 coils
AHU 7	2	PH 703	6/15/2023	July 31 - Aug 4	2970	10x5x4	1 crate 2 coils
AHU 8	2	PH 703	6/15/2023	Aug 7 - Aug 11	3870	10x5x4	1 crate 2 coils
AHU 9	2	PH 703	6/15/2023	Aug 14 - Aug 18	3276	10x5x4	1 crate 2 coils
Pav WH							
AHU4 HW	1	MRISC 65	3/27/2023	June 19 - June 23	Currently at Vaughan Warehouse		

NOTE: Med Science CW coils are presently sitting on cinder blocks. Include replacing cinder blocks with steel structure.

DIE NUMBER	1
FACE TUBES	30
# CIRCUITS	29
PASS / CIRCUIT	8
TUBE MATERIAL	
0.625 x 0.035 Copper SMOOTH	
FIN MATERIAL	
10 FINS PER INCH 0.0095 Aluminum Corr	
CASING MATERIAL	
14 GAUGE 304 S.S.	
HEADER MATERIAL	
TYPE L Copper	
HEADER SIZES	
SUPPLY: 3" NOM RETURN: 3" NOM	
CONNECTIONS	
SUPPLY: 3" NOM TYPE L Copper	
RETURN: 3" NOM TYPE L Copper	
DRY WEIGHT	
1131 Lbs./Coil	
INTERNAL VOLUME	
3.95 GAL PER COIL	
TEST PRESSURE	
na	
CASING STYLE	
STANDARD	
COIL QTY	2
FEATURES:	
Lifting Bracket (2)	
MPT Conn. Red Brass (2)	
Vent and Drain (2)	

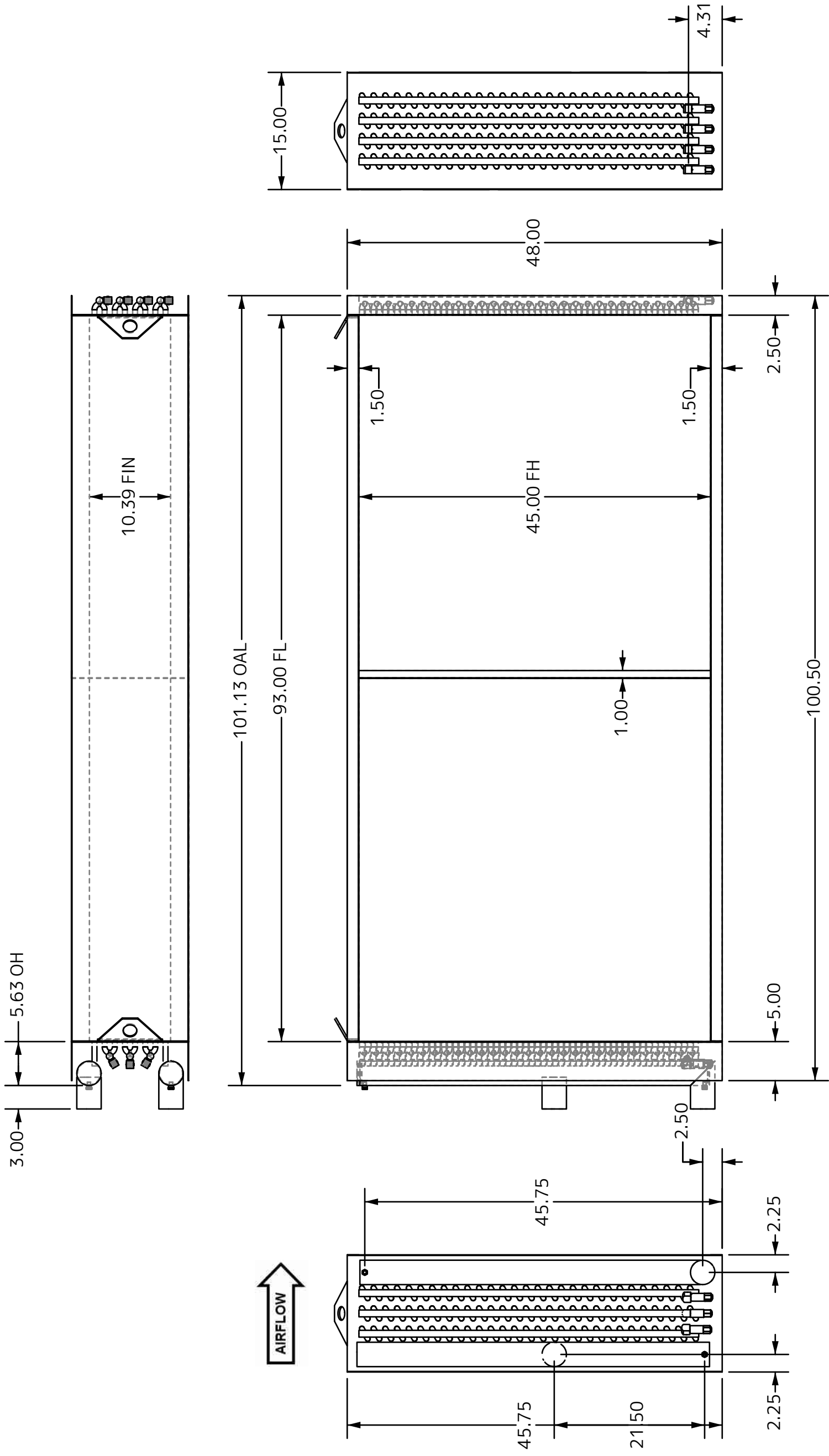

COIL DESCRIPTION		FLUID 45x93 - 8R - 0.625/120	
DATE	CUST. P/N	DATE	CUST. P/N
03/10/2023		03/10/2023	Med SCI AHU-2
CUSTOMER		CUSTOMER	
COIL I.D.	V10008407	REV	R0
NOTES:		COPYRIGHT © SUPER RADIATOR COILS THIS DRAWING IS THE EXCLUSIVE PROPERTY OF SUPER RADIATOR COILS. DUPLICATION OR COPYING OF THIS DRAWING BY OTHERS FOR ANY REASON, UNLESS EXPRESSLY APPROVED IN WRITING BY SUPER RADIATOR COILS, IS PROHIBITED BY LAW. VIOLATORS WILL BE PROSECUTED.	
COINNEY / FREEZE BLOCK POWERED BY		COINNEY / FREEZE BLOCK POWERED BY	

DIE NUMBER	1
FACE TUBES	30
# CIRCUITS	58
PASS / CIRCUIT	4
TUBE MATERIAL	
0.625 x 0.035	
Copper SMOOTH	
FIN MATERIAL	
10 FINS PER INCH	
0.0095 Aluminum	
Corr	
CASING MATERIAL	
12 GAUGE	
304 S.S.	
HEADER MATERIAL	
TYPE L Copper	
HEADER SIZES	
SUPPLY: 4" NOM	
RETURN: 4" NOM	
CONNECTIONS	
SUPPLY: 3" NOM	
TYPE L Copper	
RETURN: 3" NOM	
TYPE L Copper	
DRY WEIGHT	
1465 Lbs./Coil	
INTERNAL VOLUME	
4.96 GAL PER COIL	
TEST PRESSURE	
200 PSIG	
CASING STYLE	
STANDARD	
COIL QTY	2
FEATURES:	
Lifting Bracket (2)	
Stacking Flange	
MPT Conn. Red Brass (2)	
Vent and Drain (4)	

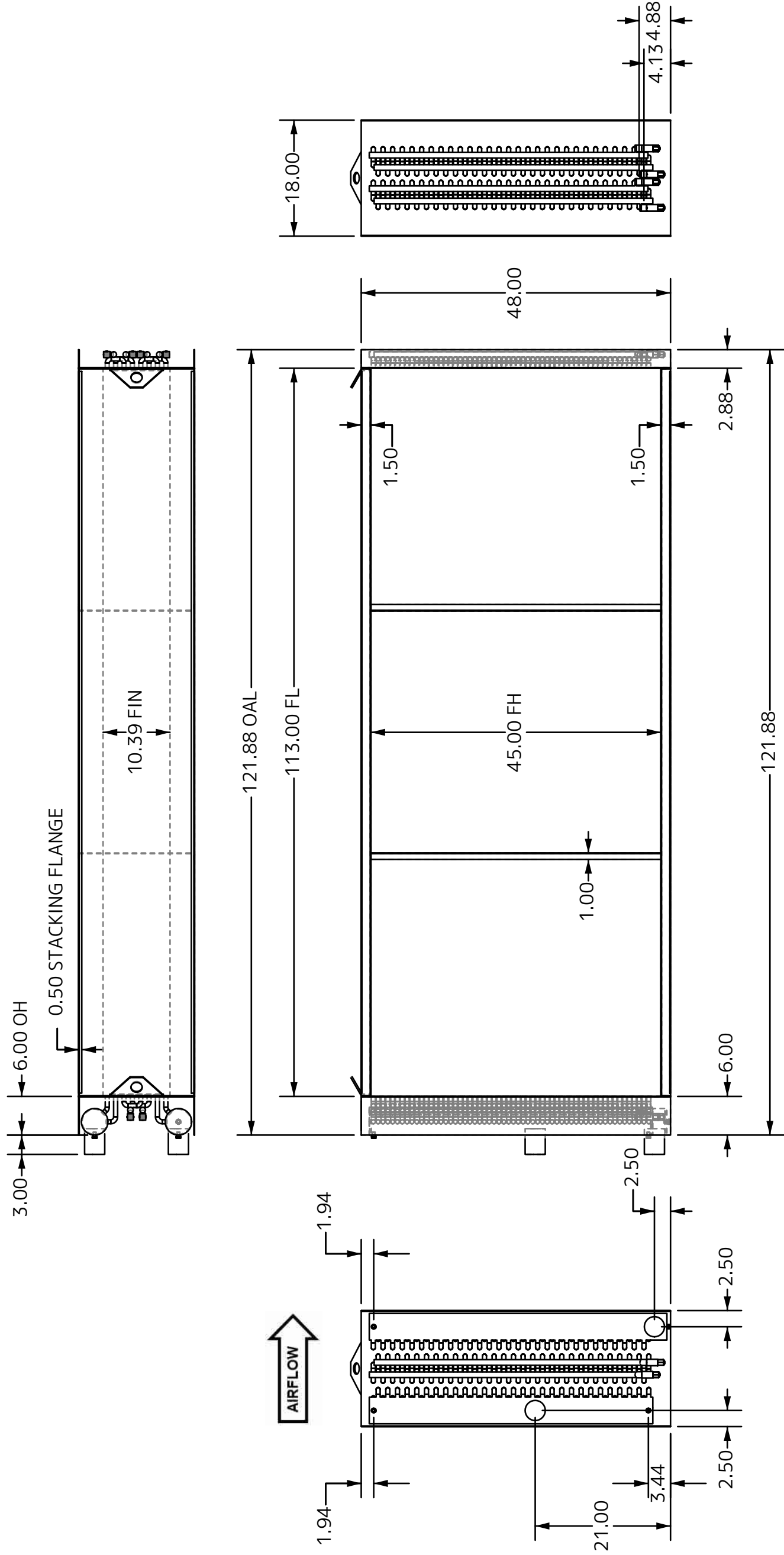

COIL DESCRIPTION	FLUID 45x113 - 8R - 0.625/120		
DATE	03/10/2023	CUST. P/N	MED SCI AHU-3
CUSTOMER			
COIL I.D.	V10008398	REV	R0
NOTES:	<p>COPYRIGHT © SUPER RADIATOR COILS          THIS DRAWING IS THE EXCLUSIVE PROPERTY          OF SUPER RADIATOR COILS.          DUPLICATION OR COPYING OF THIS DRAWING          BY OTHERS FOR ANY REASON,          UNLESS EXPRESSLY APPROVED IN WRITING BY          SUPER RADIATOR COILS, IS          PROHIBITED BY LAW. VIOLATORS WILL BE          PROSECUTED.</p>		
			



DIE NUMBER	1
FACE TUBES	30
# CIRCUITS	29
PASS / CIRCUIT	10
TUBE MATERIAL	
0.625 x 0.035	
Copper SMOOTH	
FIN MATERIAL	
8 FINS PER INCH	
0.0095 Aluminum	
Corr	
CASING MATERIAL	
12 GAUGE	
304 S.S.	
HEADER MATERIAL	
TYPE L Copper	
HEADER SIZES	
SUPPLY: 3" NOM	
RETURN: 3" NOM	
CONNECTIONS	
SUPPLY: 3" NOM	
Sch 40 Carbon Steel	
RETURN: 3" NOM	
Sch 40 Carbon Steel	
DRY WEIGHT	
1295 Lbs./Coil	
INTERNAL VOLUME	
4.85 GAL PER COIL	
TEST PRESSURE	
200 PSIG	
CASING STYLE	
STANDARD	
COIL QTY	2
FEATURES:	
Lifting Bracket (2)	
Stacking Flange	
Grooved Mech. Conn. (2)	
Vent and Drain (4)	

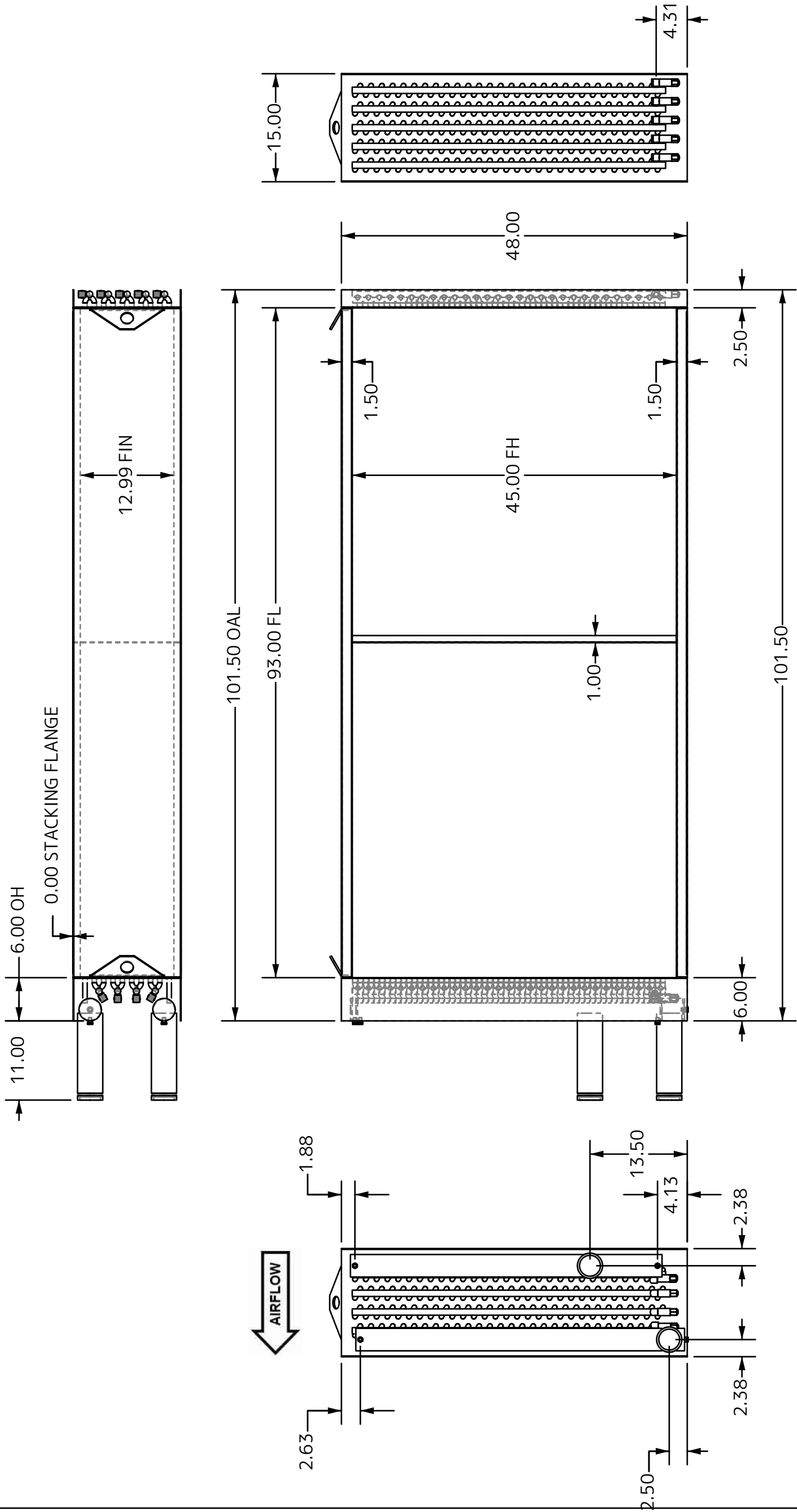

NOTES:  
 COPYRIGHT © SUPER RADIATOR COILS  
 THIS DRAWING IS THE EXCLUSIVE PROPERTY  
 OF SUPER RADIATOR COILS.  
 DUPLICATION OR COPYING OF THIS DRAWING  
 BY OTHERS FOR ANY REASON,  
 UNLESS EXPRESSLY APPROVED IN WRITING BY  
 SUPER RADIATOR COILS, IS  
 PROHIBITED BY LAW. VIOLATORS WILL BE  
 PROSECUTED.



COIL DESCRIPTION  
 FLUID 45x93 - 10R - 0.625/96  
 DATE  
 03/10/2023  
 CUSTOMER  
 MED SCI AHU-5

COIL I.D. V10008399  
 REV  
 R0

DIE NUMBER	1
FACE TUBES	28
# CIRCUITS	54
PASS / CIRCUIT	4
TUBE MATERIAL	
0.625 x 0.035 Copper SMOOTH	
FIN MATERIAL	
9 FINS PER INCH 0.0095 Aluminum Corr	
CASING MATERIAL	
14 GAUGE 304 S.S.	
HEADER MATERIAL	
TYPE L Copper	
HEADER SIZES	
SUPPLY: 3" NOM RETURN: 3" NOM	
CONNECTIONS	
SUPPLY: 3" NOM TYPE L Copper	
RETURN: 3" NOM TYPE L Copper	
DRY WEIGHT	
1072 Lbs./Coil	
INTERNAL VOLUME	
3.74 GAL PER COIL	
TEST PRESSURE	
200 PSIG	
CASING STYLE	
STANDARD	
COIL QTY	2

FEATURES:  
Lifting Bracket (2)  
Stacking Flange  
MPT Conn. Red Brass (2)  
Vent and Drain (4)

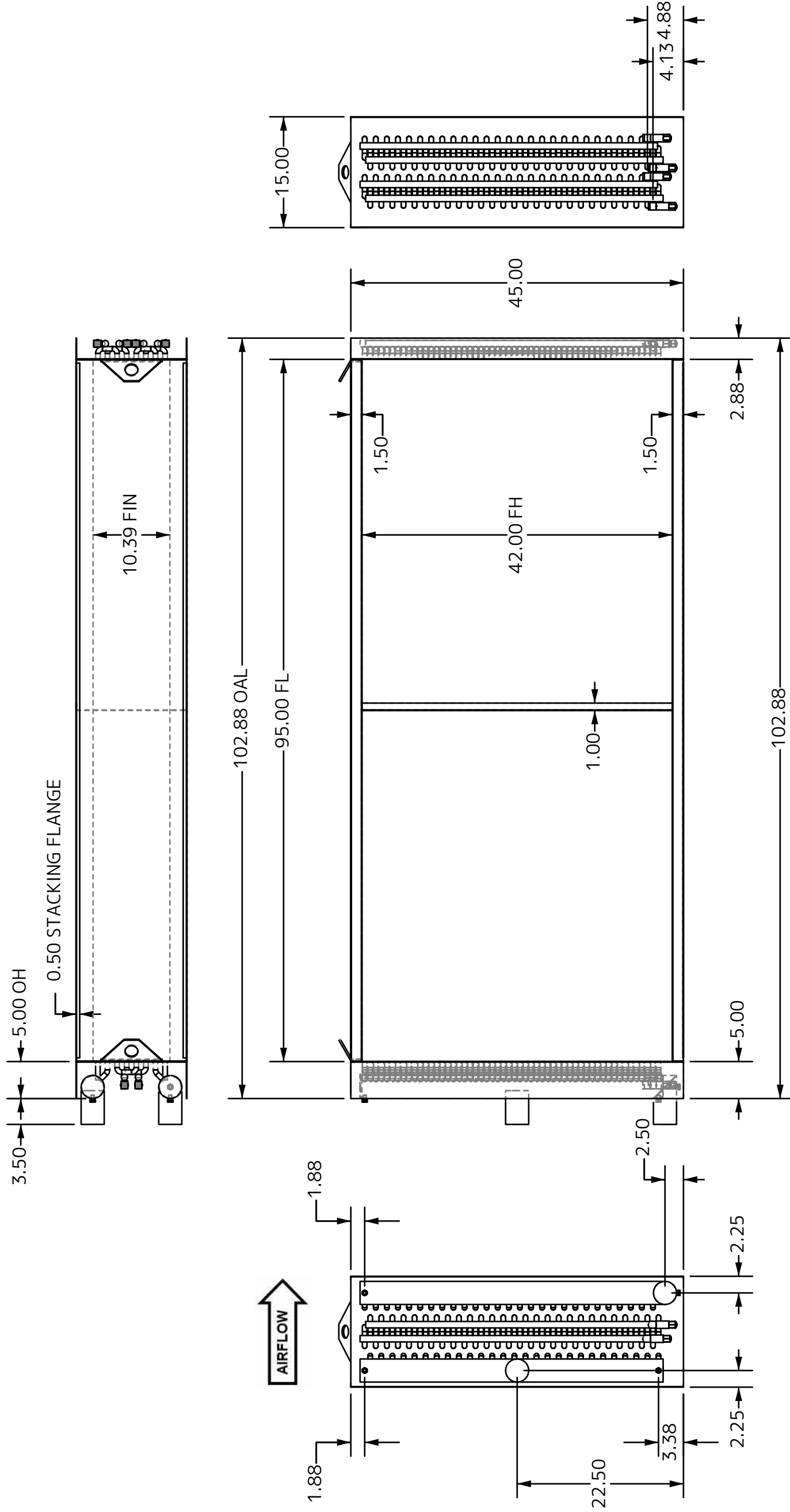

COIL DESCRIPTION		FLUID 42x95 - 8R - 0.625/108	
DATE	03/10/2023	CUST. P/N	MED SCI AHU-6
CUSTOMER			
COIL I.D.	V10008406	REV	R0

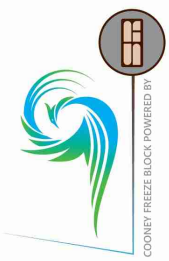

NOTES:  
COPYRIGHT © SUPER RADIATOR COILS  
THIS DRAWING IS THE EXCLUSIVE PROPERTY  
OF SUPER RADIATOR COILS.  
DUPLICATION OR COPYING OF THIS DRAWING  
BY OTHERS FOR ANY REASON,  
UNLESS EXPRESSLY APPROVED IN WRITING BY  
SUPER RADIATOR COILS, IS  
PROHIBITED BY LAW. VIOLATORS WILL BE  
PROSECUTED.

DIE NUMBER	1
FACE TUBES	28
# CIRCUITS	54
PASS / CIRCUIT	4
TUBE MATERIAL	
0.625 x 0.035 Copper SMOOTH	
FIN MATERIAL	
9 FINS PER INCH 0.0095 Aluminum Corr	
CASING MATERIAL	
12 GAUGE 304 S.S.	
HEADER MATERIAL	
TYPE L Copper	
HEADER SIZES	
SUPPLY: 3" NOM RETURN: 3" NOM	
CONNECTIONS	
SUPPLY: 3" NOM TYPE L Copper	
RETURN: 3" NOM TYPE L Copper	
DRY WEIGHT	
1052 Lbs./Coil	
INTERNAL VOLUME	
3.67 GAL PER COIL	
TEST PRESSURE	
200 PSIG	
CASING STYLE	
STANDARD	
COIL QTY	2

FEATURES:  
Lifting Bracket (2)  
Stacking Flange  
MPT Conn. Red Brass (2)  
Vent and Drain (4)

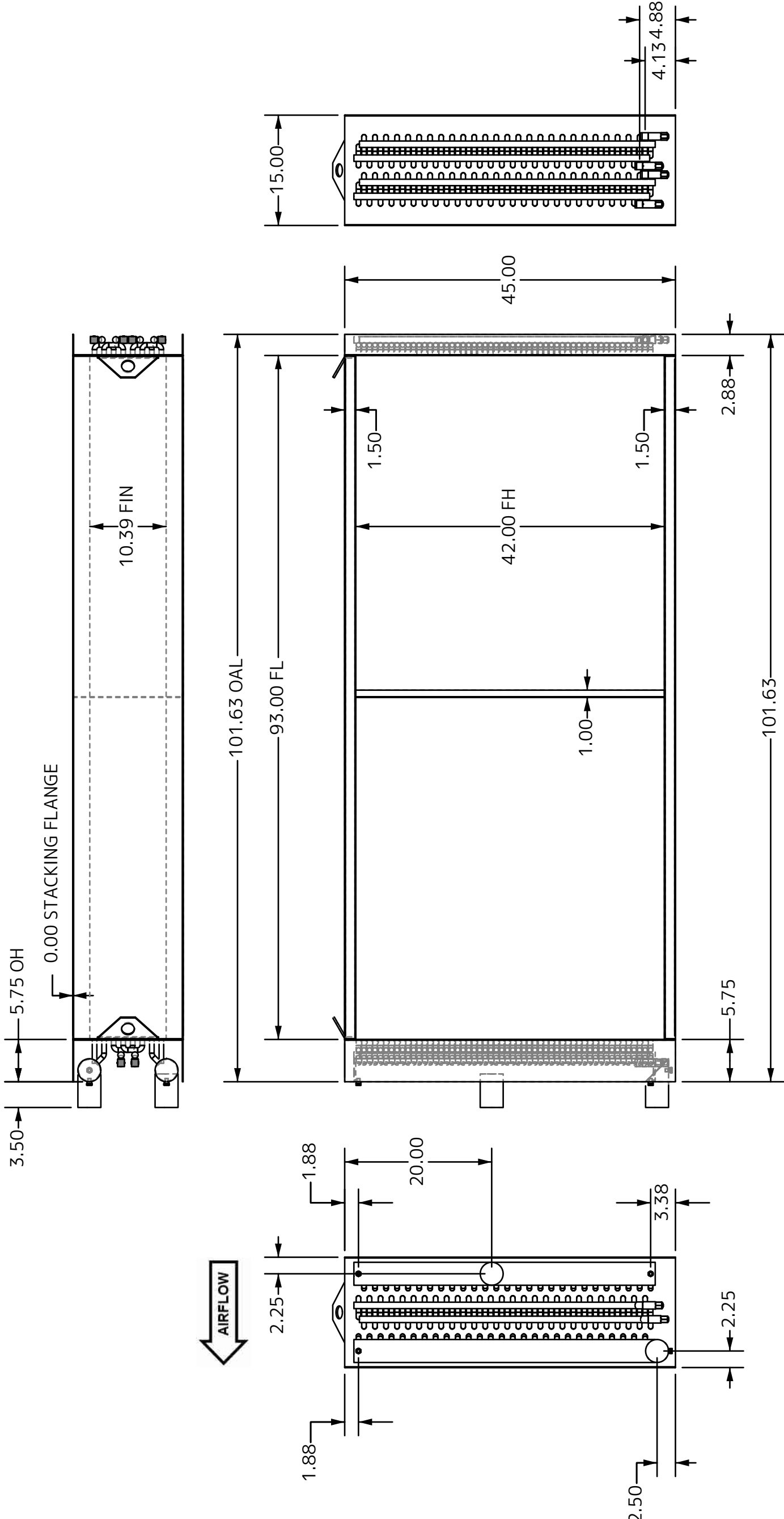

COIL DESCRIPTION	FLUID 42x93 - 8R - 0.625/108	
DATE	03/10/2023	CUST. P/N
CUSTOMER	MED SCI AHU-7	
COIL I.D.	V10008403	
REV	R0	

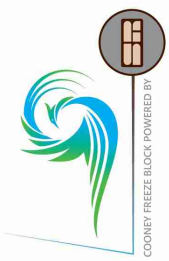

NOTES:  
COPYRIGHT © SUPER RADIATOR COILS  
THIS DRAWING IS THE EXCLUSIVE PROPERTY  
OF SUPER RADIATOR COILS.  
DUPLICATION OR COPYING OF THIS DRAWING  
BY OTHERS FOR ANY REASON,  
UNLESS EXPRESSLY APPROVED IN WRITING BY  
SUPER RADIATOR COILS, IS  
PROHIBITED BY LAW. VIOLATORS WILL BE  
PROSECUTED.

DIE NUMBER	1
FACE TUBES	29
# CIRCUITS	28
PASS / CIRCUIT	10
TUBE MATERIAL	
0.625 x 0.035	
Copper SMOOTH	
FIN MATERIAL	
9 FINS PER INCH	
0.0095 Aluminum	
Corr	
CASING MATERIAL	
12 GAUGE	
304 S.S.	
HEADER MATERIAL	
TYPE L Copper	
HEADER SIZES	
SUPPLY: 4" NOM	
RETURN: 4" NOM	
CONNECTIONS	
SUPPLY: 3" NOM	
TYPE L Copper	
RETURN: 3" NOM	
TYPE L Copper	
DRY WEIGHT	
1296 Lbs./Coil	
INTERNAL VOLUME	
4.9 GAL PER COIL	
TEST PRESSURE	
200 PSIG	
CASING STYLE	
STANDARD	
COIL QTY	2
FEATURES:	
Lifting Bracket (2)	
Stacking Flange	
MPT Conn. Red Brass (2)	
Vent and Drain (4)	

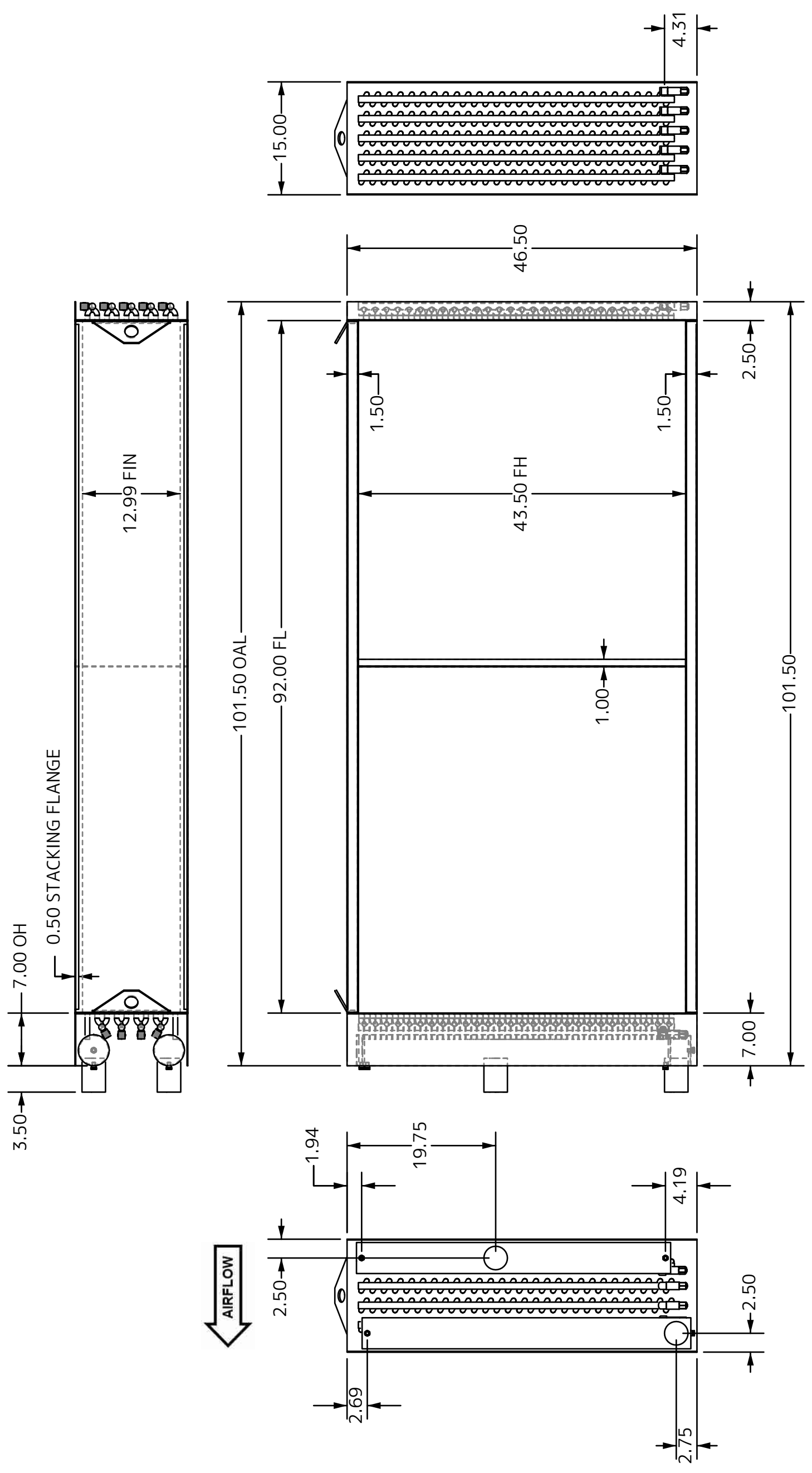

COIL DESCRIPTION		FLUID 43.5x92 - 10R - 0.625/108	
DATE	03/10/2023	CUST. P/N	MED SCI AHU-8
CUSTOMER		MED SCI AHU-8	
COIL I.D.		V10008401	
NOTES:		<p>COPYRIGHT © SUPER RADIATOR COILS          THIS DRAWING IS THE EXCLUSIVE PROPERTY          OF SUPER RADIATOR COILS.          DUPLICATION OR COPYING OF THIS DRAWING          BY OTHERS FOR ANY REASON,          UNLESS EXPRESSLY APPROVED IN WRITING BY          SUPER RADIATOR COILS, IS          PROHIBITED BY LAW. VIOLATORS WILL BE          PROSECUTED.</p>	
REV		R0	

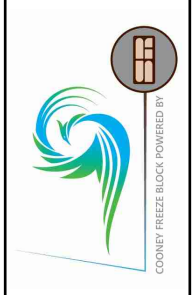





DATE: 09-23-12  
 DRAWN BY: FR

BLDG # 0298

**WILLIAM R. WILLARD MEDICAL EDUCATION BUILDING**

**KEY DRAWING**

**UNIVERSITY OF KENTUCKY**  
 ITS Information Services

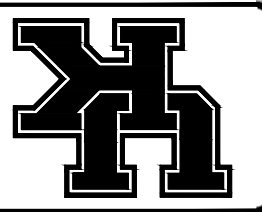

**SHEET**  
 1 of 10

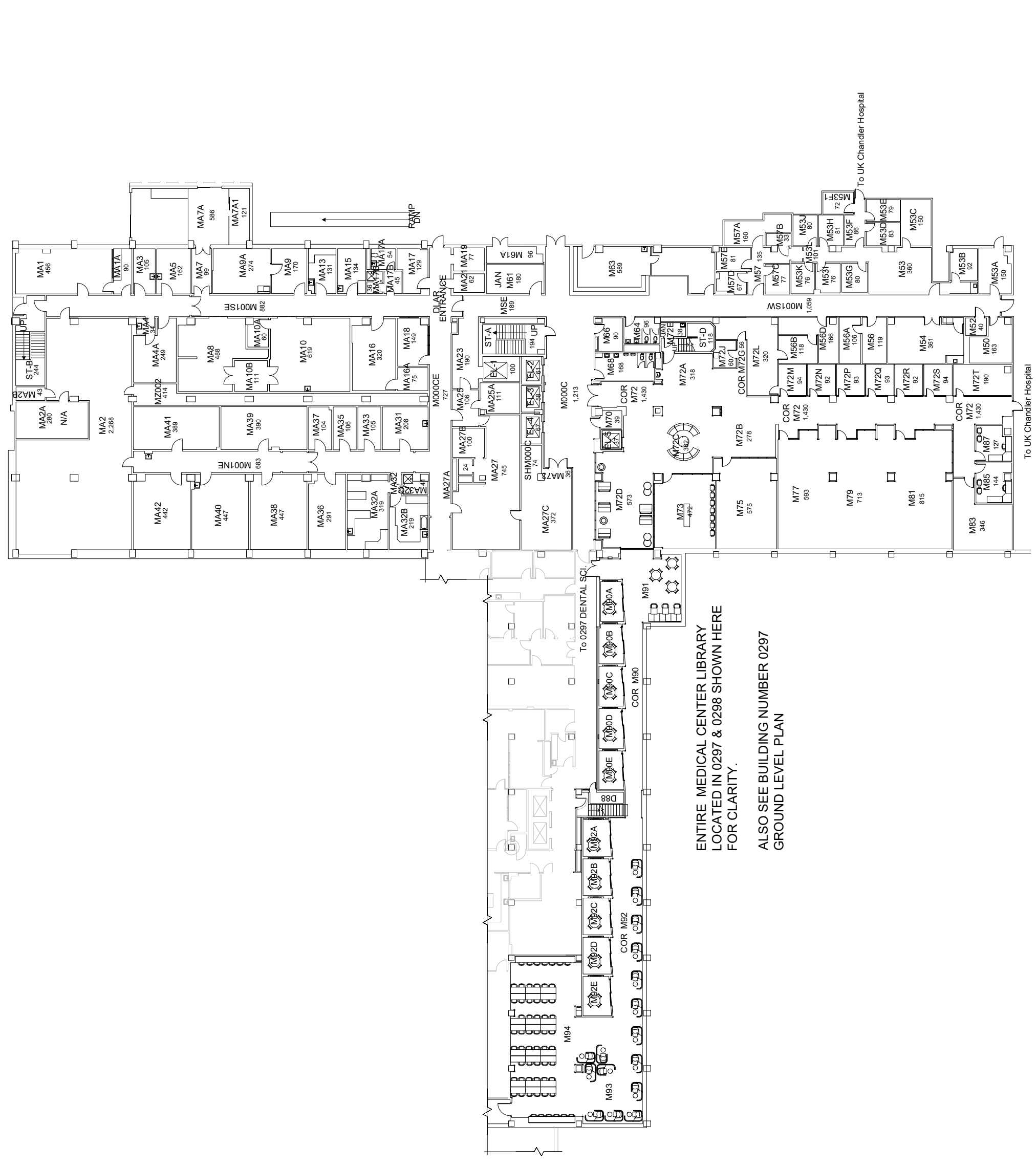

ENTIRE MEDICAL CENTER LIBRARY  
 LOCATED IN 0297 & 0298 SHOWN HERE  
 FOR CLARITY.  
 ALSO SEE BUILDING NUMBER 0297  
 GROUND LEVEL PLAN



**GROUND FLOOR PLAN**  
**WILLIAM R. WILLARD**  
**MEDICAL EDUCATION BUILDING**  
 34,558 Gross Square Ft.

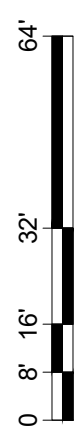

DATE: 09-23-12  
DRAWN BY: FR

BLDG # 0298

# WILLIAM R. WILLARD MEDICAL EDUCATION BUILDING

KEY DRAWING

UNIVERSITY OF KENTUCKY  
ITS Information Services

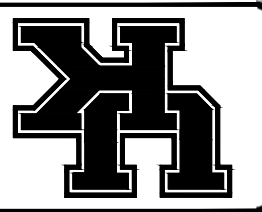

SHEET  
2 of 10

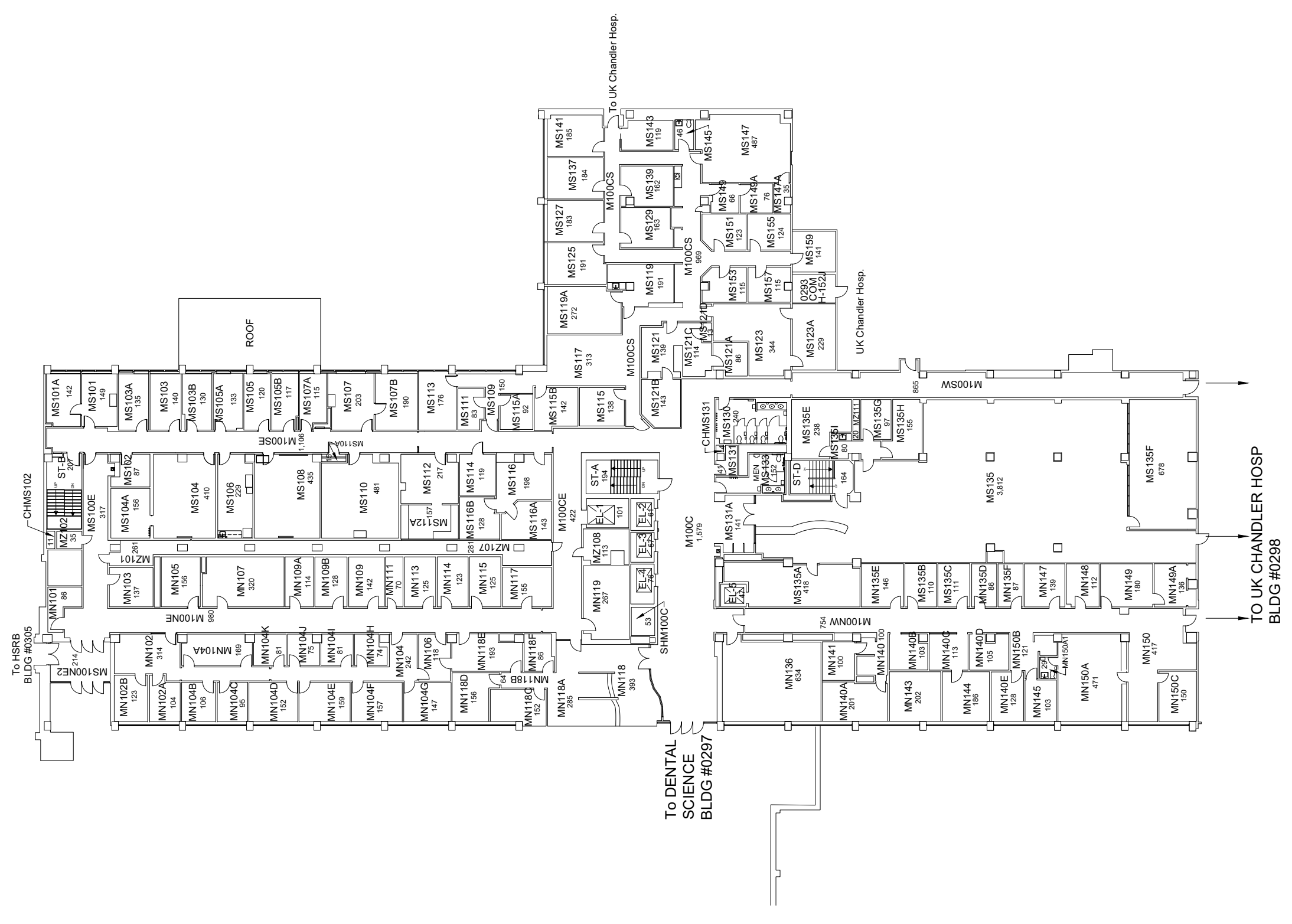

## FIRST FLOOR PLAN WILLIAM R. WILLARD MEDICAL EDUCATION BUILDING

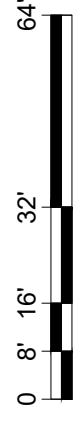

38,161 Gross Square Ft.

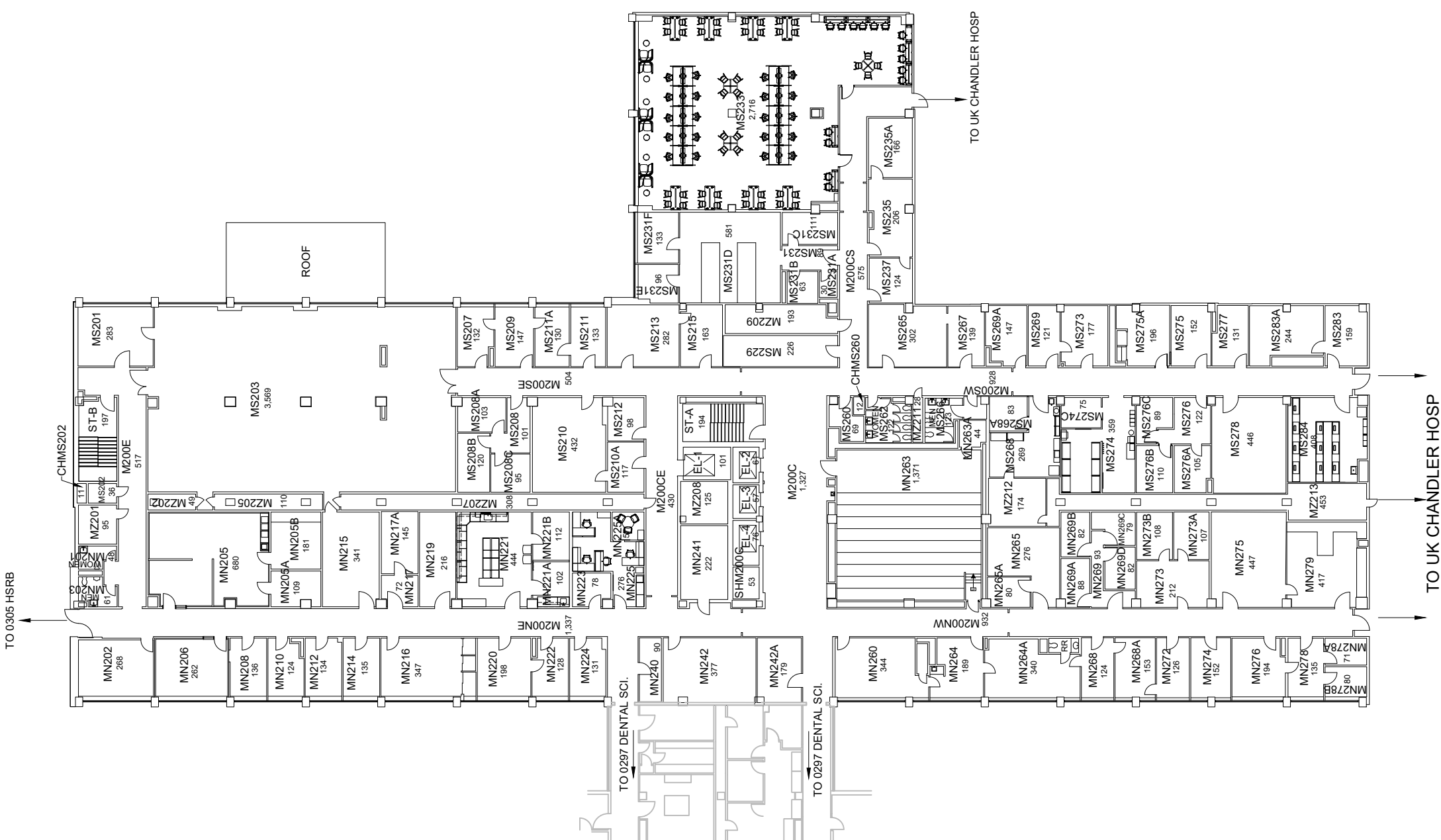

**SECOND FLOOR PLAN**  
**WILLIAM R. WILLARD**  
**MEDICAL EDUCATION BUILDING**



38,028 Gross Square Ft.

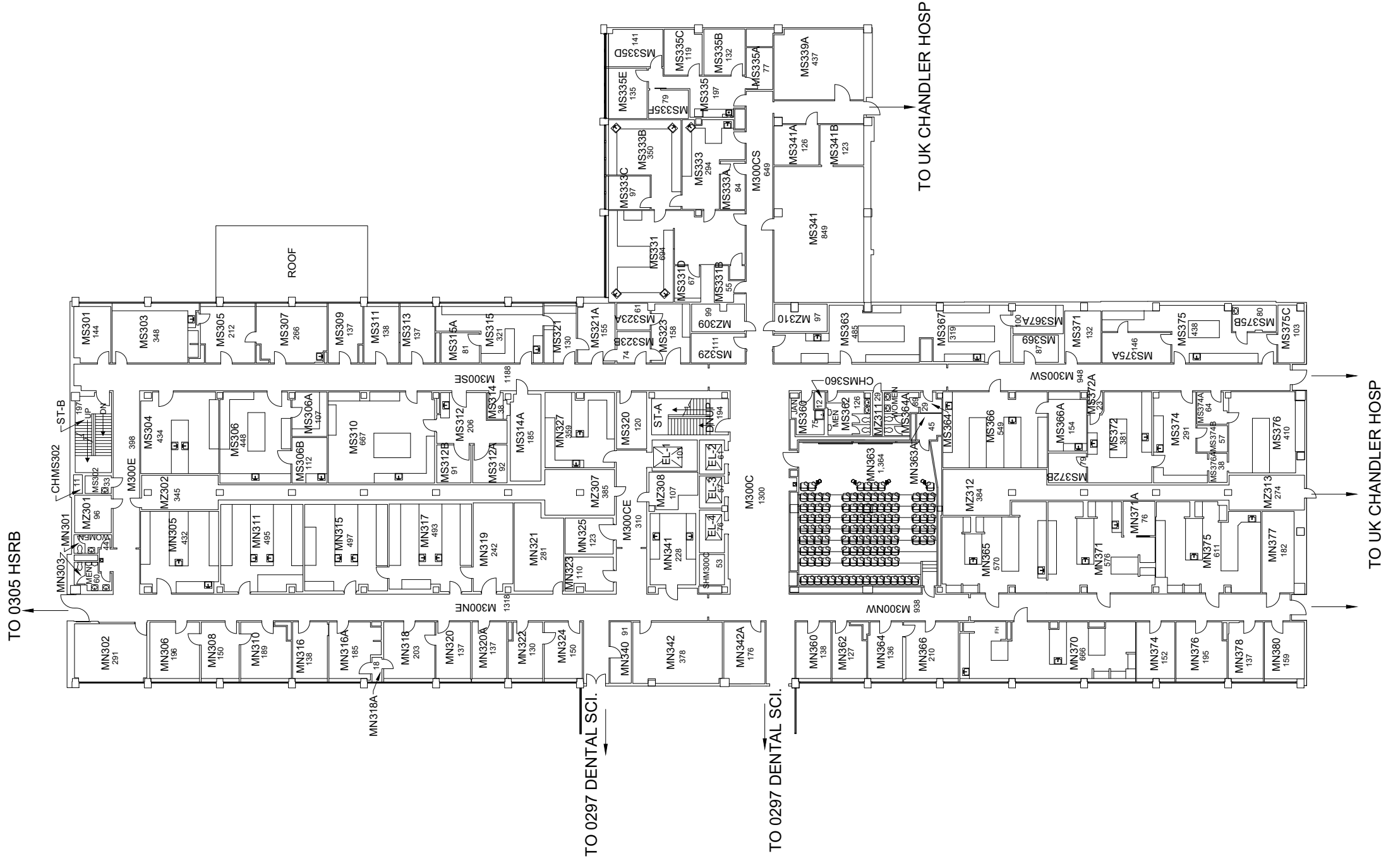

**THIRD FLOOR PLAN**  
**WILLIAM R. WILLARD**  
**MEDICAL EDUCATION BUILDING**



37,931 Gross Square Ft.

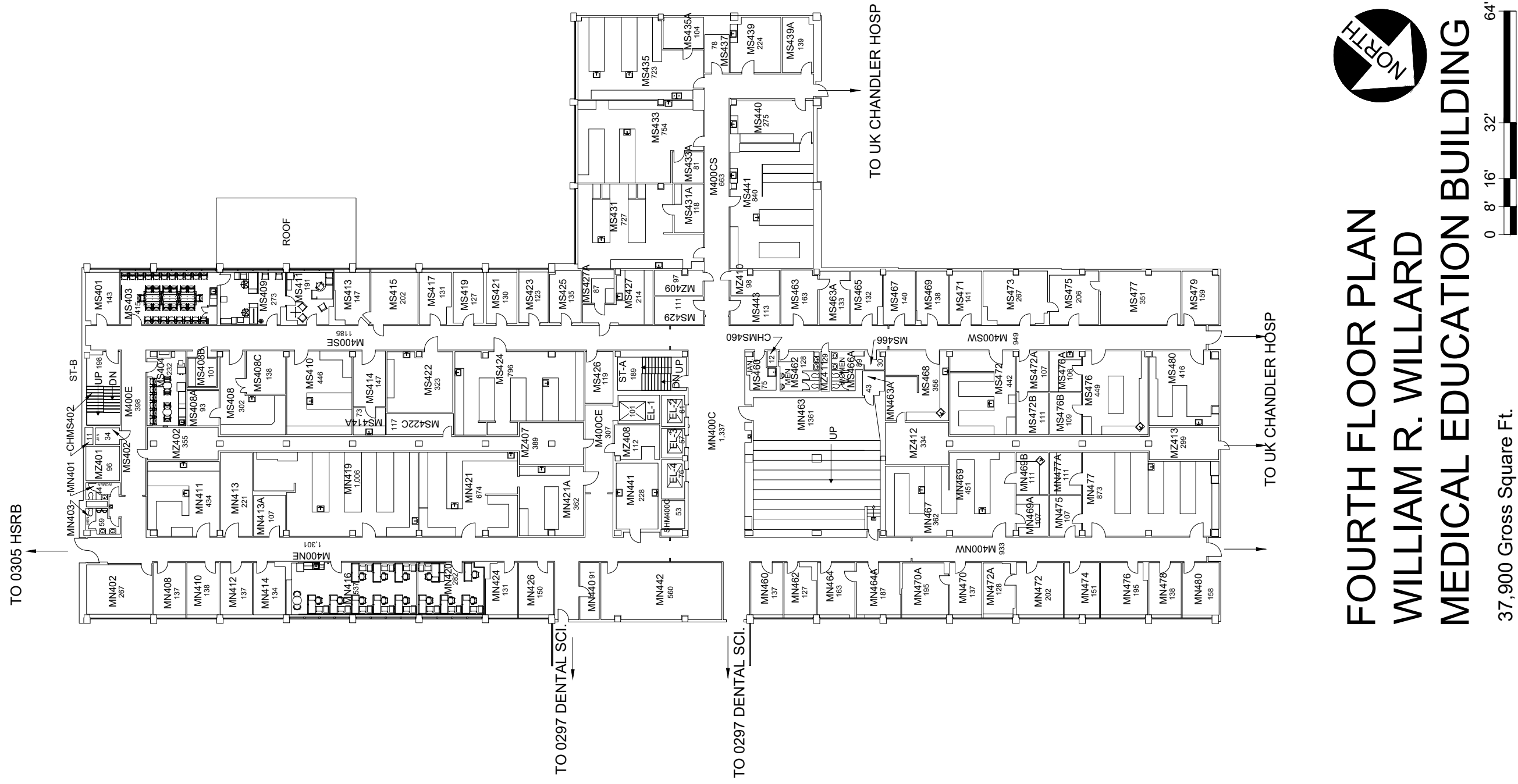

FOURTH FLOOR PLAN  
WILLIAM R. WILLARD  
MEDICAL EDUCATION BUILDING



37,900 Gross Square Ft.

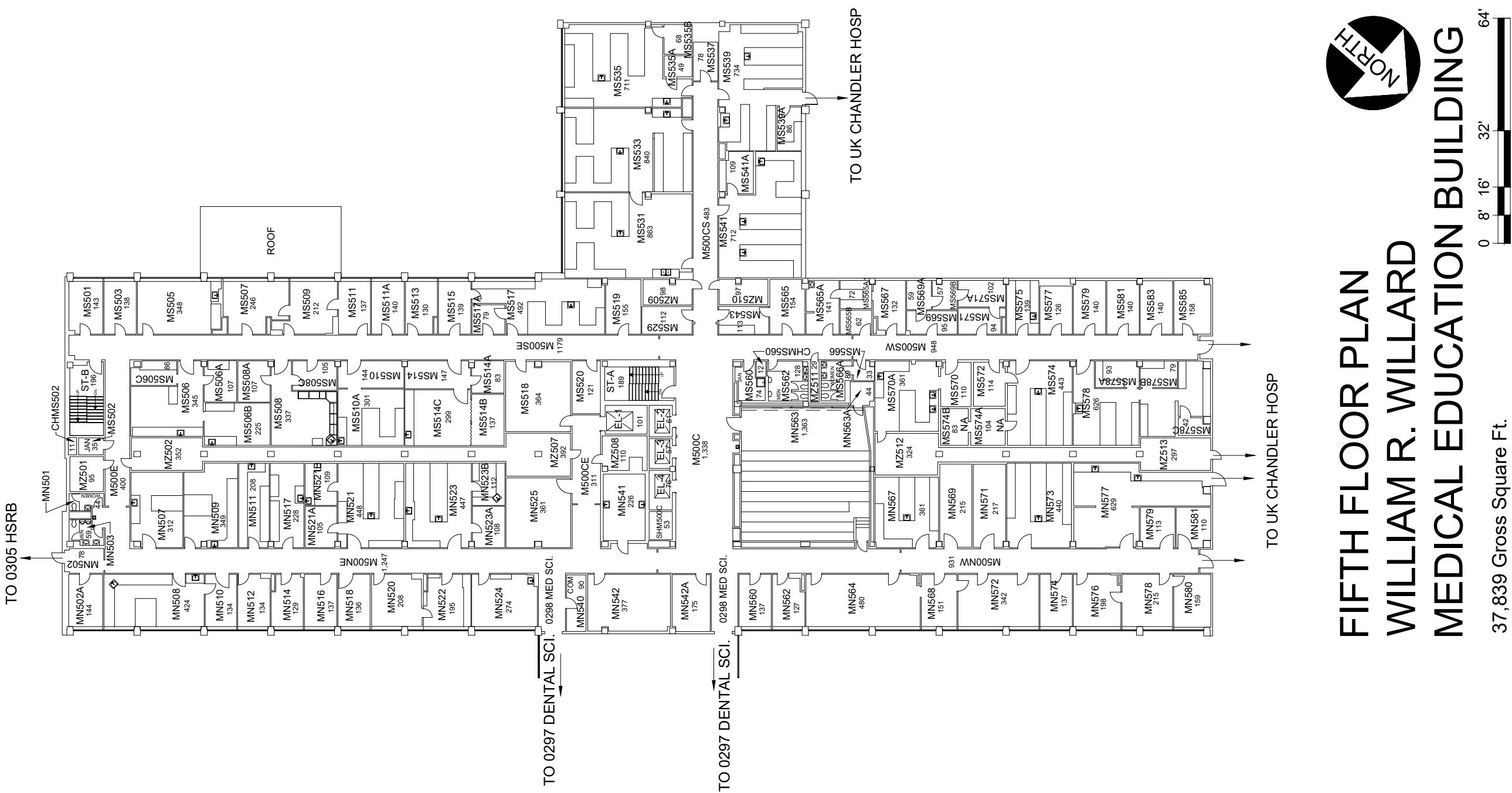
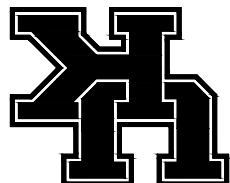

FIFTH FLOOR PLAN  
WILLIAM R. WILLARD  
MEDICAL EDUCATION BUILDING

37,839 Gross Square Ft.

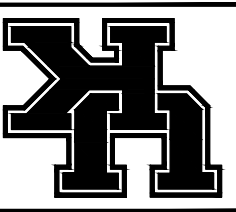

**SIXTH FLOOR PLAN**  
**WILLIAM R. WILLARD**  
**MEDICAL EDUCATION BUILDING**

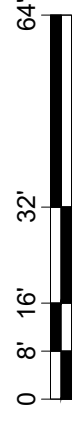

37,865 Gross Square Ft.

TO UK CHANDLER HOSP.

TO UK CHANDLER HOSP.

TO 0297 DENTAL SCI.

TO 0298 MED SCI.



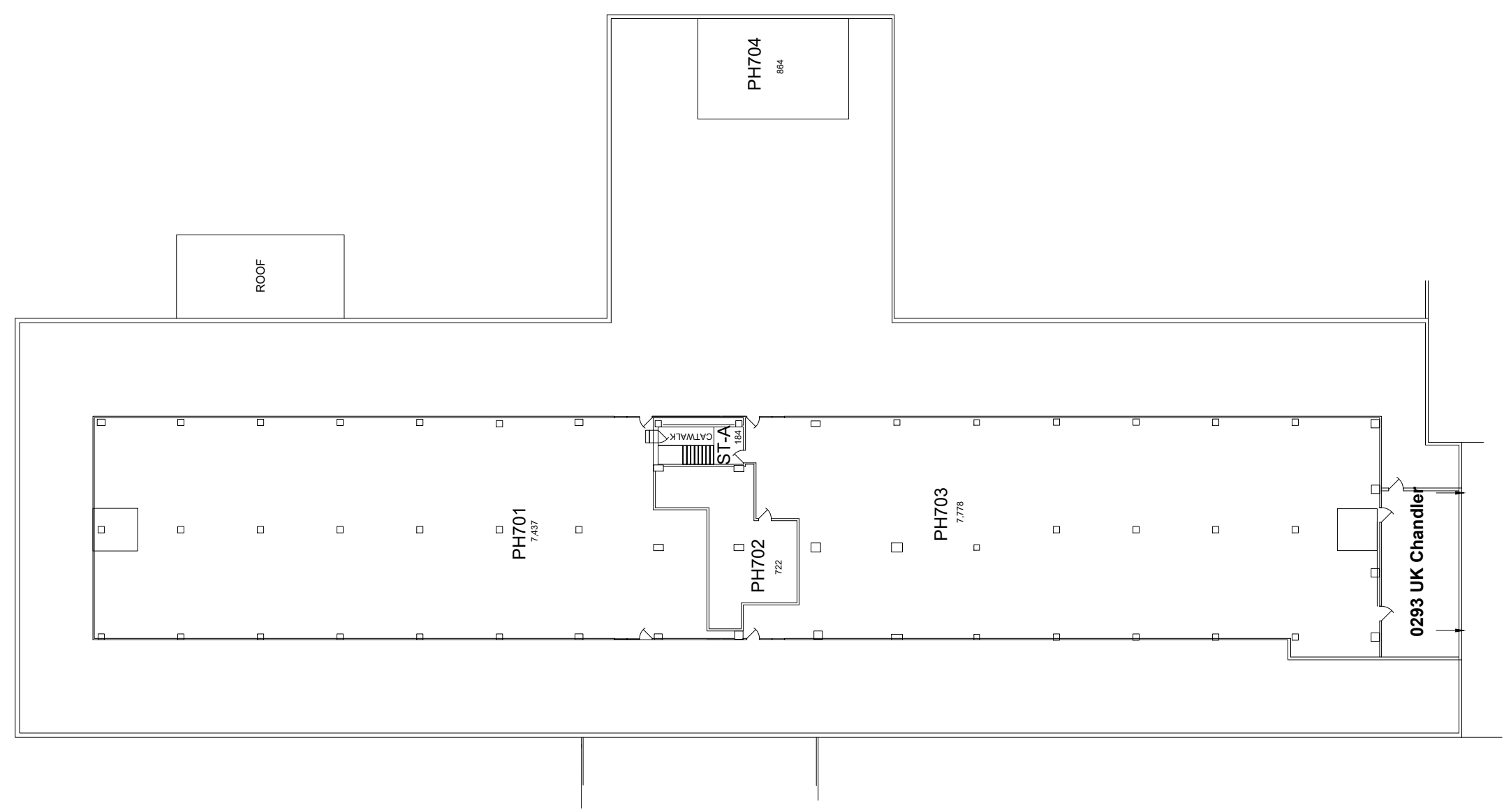
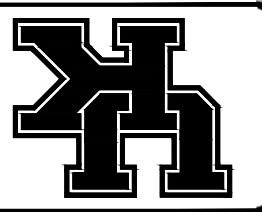

PENTHOUSE FLOOR PLAN  
WILLIAM R. WILLARD  
MEDICAL EDUCATION BUILDING



17,376 Gross Square Ft.

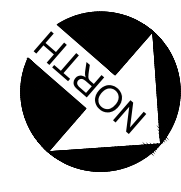
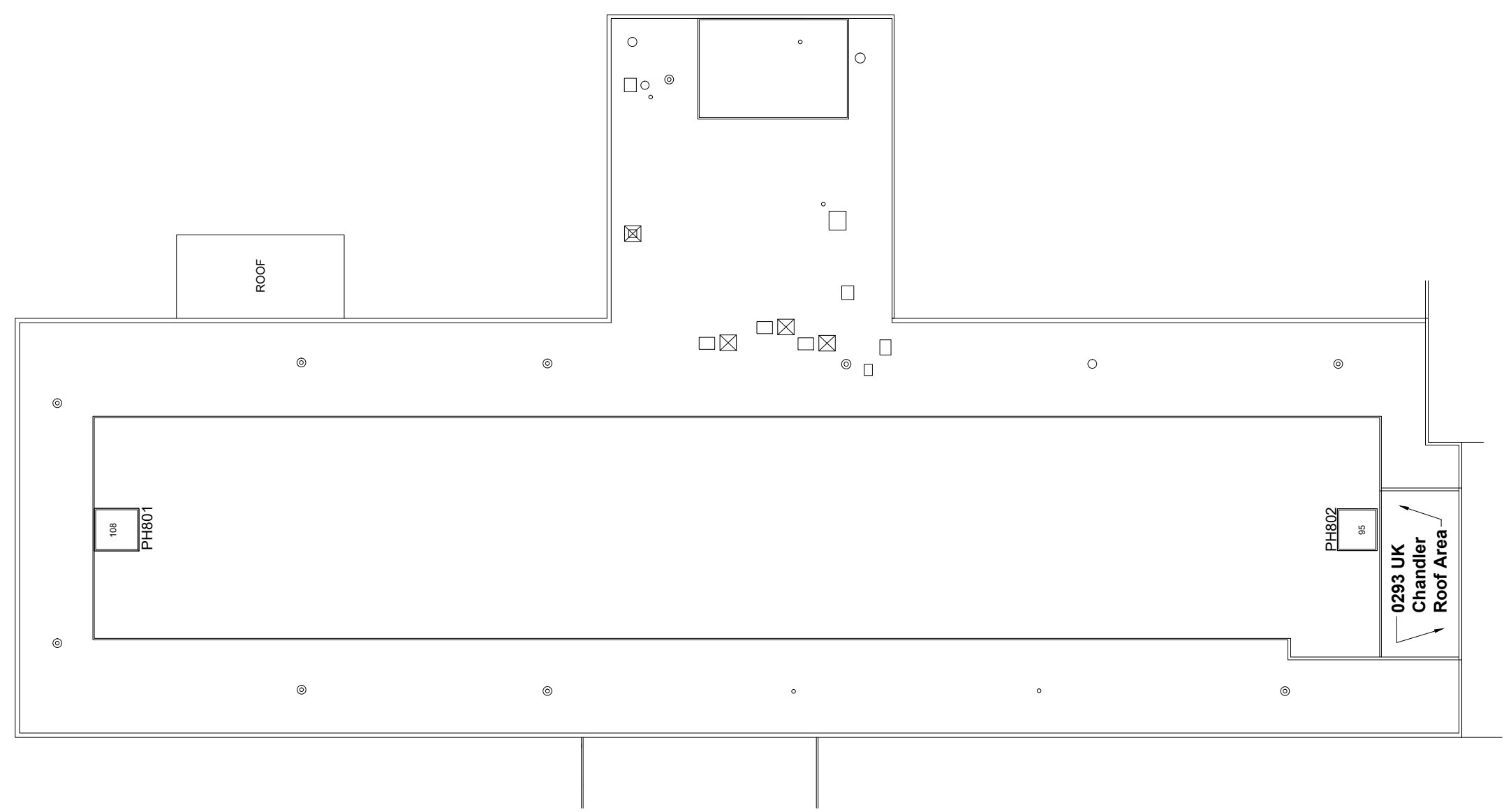
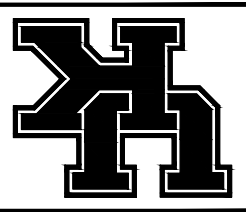

**LOUVERED  
PENTHOUSE FLOOR PLAN  
WILLIAM R. WILLARD  
MEDICAL EDUCATION BUILDING**

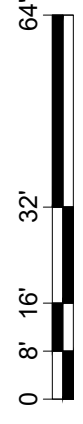

203 Gross Square Ft.

DATE: 09-23-12  
 DRAWN BY: FR

BLDG # 0298

**WILLIAM R. WILLARD MEDICAL EDUCATION BUILDING**

**KEY DRAWING**

UNIVERSITY OF KENTUCKY  
 ITS Information Services

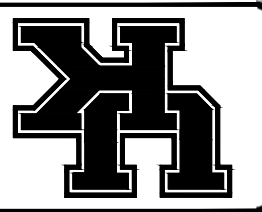

SHEET 10 of 10

**ROOF DATA**

Section	Roof Area Number	Location	Roof Type	Sq. Ft.
1	RF701	Outer Roof		19,371
2	RF802	Main Roof		16,512
3	RF803	South Roof		864
4	RF904	South Mechanical Roof		108
5	RF905	North Mechanical Roof		95
6	RF101	Low Roof		790

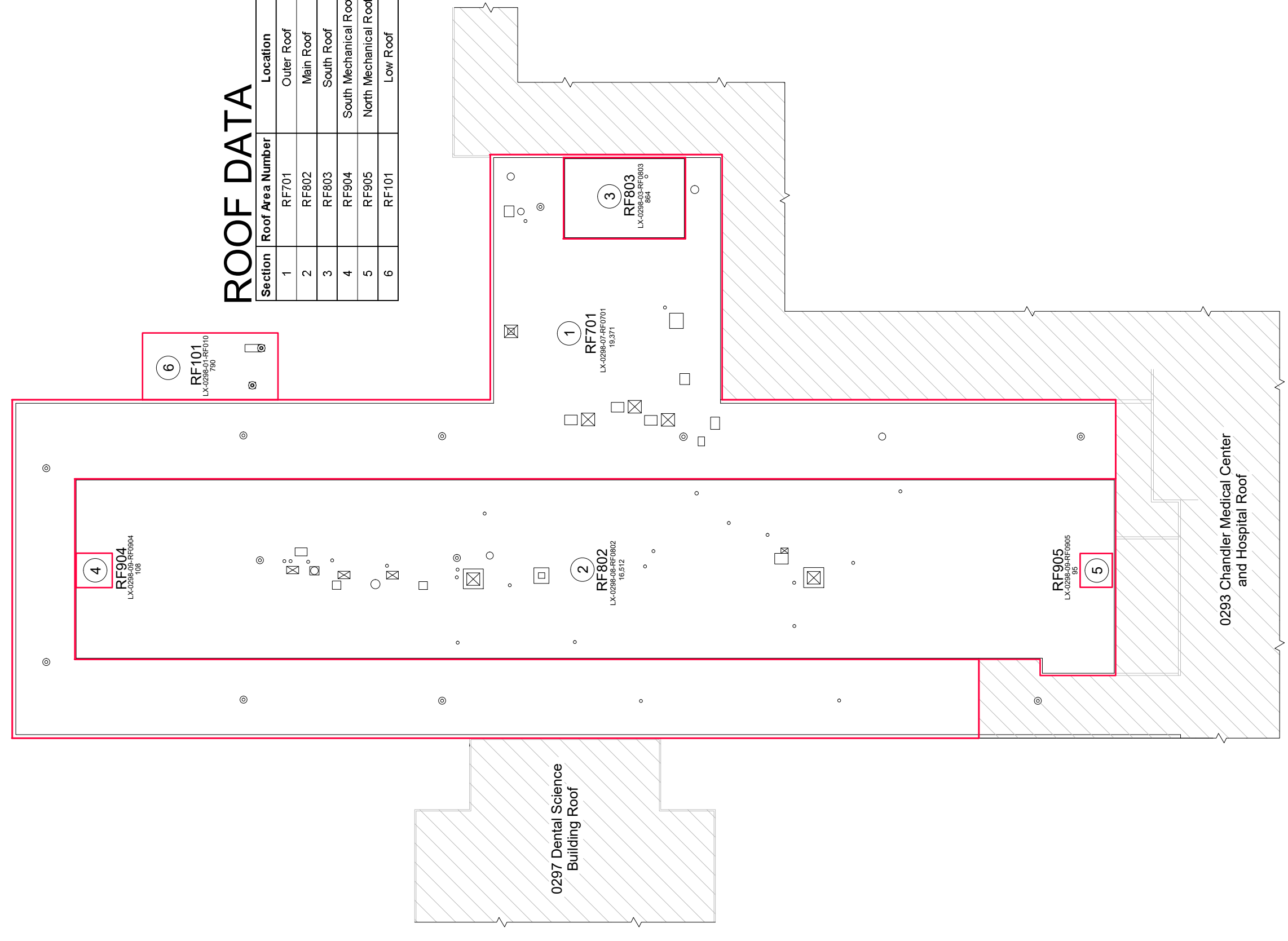

**ROOF PLAN**  
**WILLIAM R. WILLARD**  
**MEDICAL EDUCATION BUILDING**

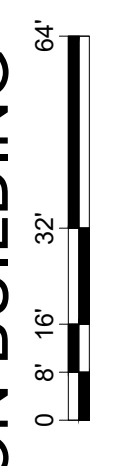

Freeze Blocks Req'd  
 Max Pressure 200 Psig  
 Fin Pack Offset: -1.50 in

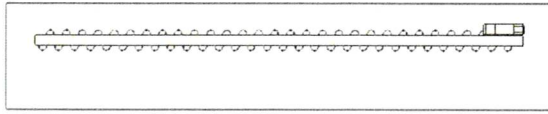
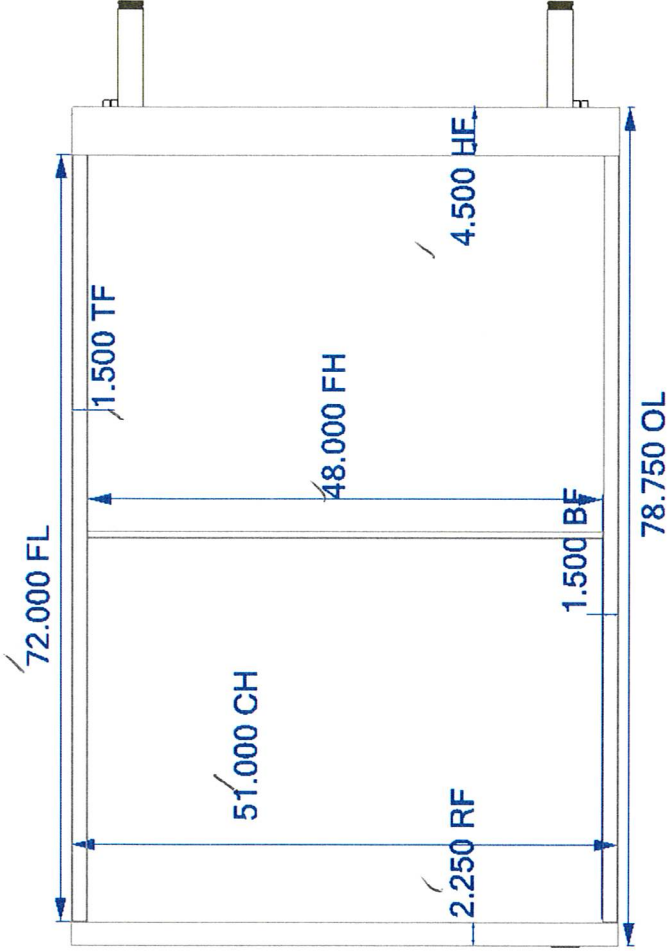
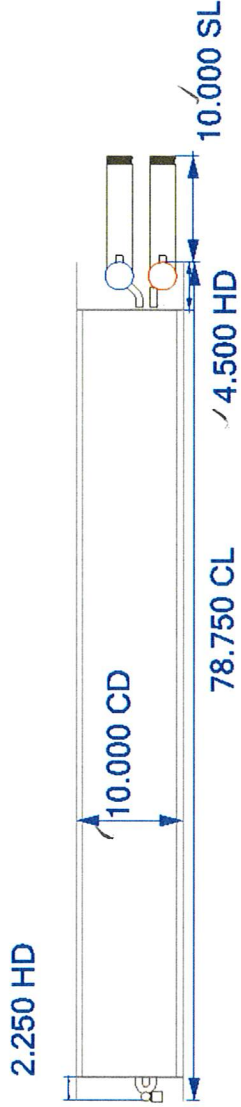

Drawing Scale: 0.055 dimensions in inches

**Tube Material:** 0.625 x 0.035 Smooth Copper  
**Fin Material:** 0.0100 Aluminum  
**Fin Type:** 5/8 OD Waffle @ 6.5 fpi  
**Casing Material:** 16 Ga. Galvanized  
**Casing Type:** Flanged w/ Stacking Flanges  
**Fastener Type:** Screws

**Rows/Feeds:** 2 rows / 31 feeds  
**Header Matl:** Copper  
**Connection Matl:** Red Brass  
**Supply HDR:** 2.625 OD / 2.000 MPT  
**Return HDR:** 2.625 OD / 2.000 MPT  
**Dry Weight:** 215.5 Lbs. per Coil

**Notes:**  
 TAG:AHU-4 MRISC

WH0206031A4C35G16-48.00X72.0L

Drawing: 0006830 Rev: 4



APPROVED  
 1-13-23  
 [Signature]



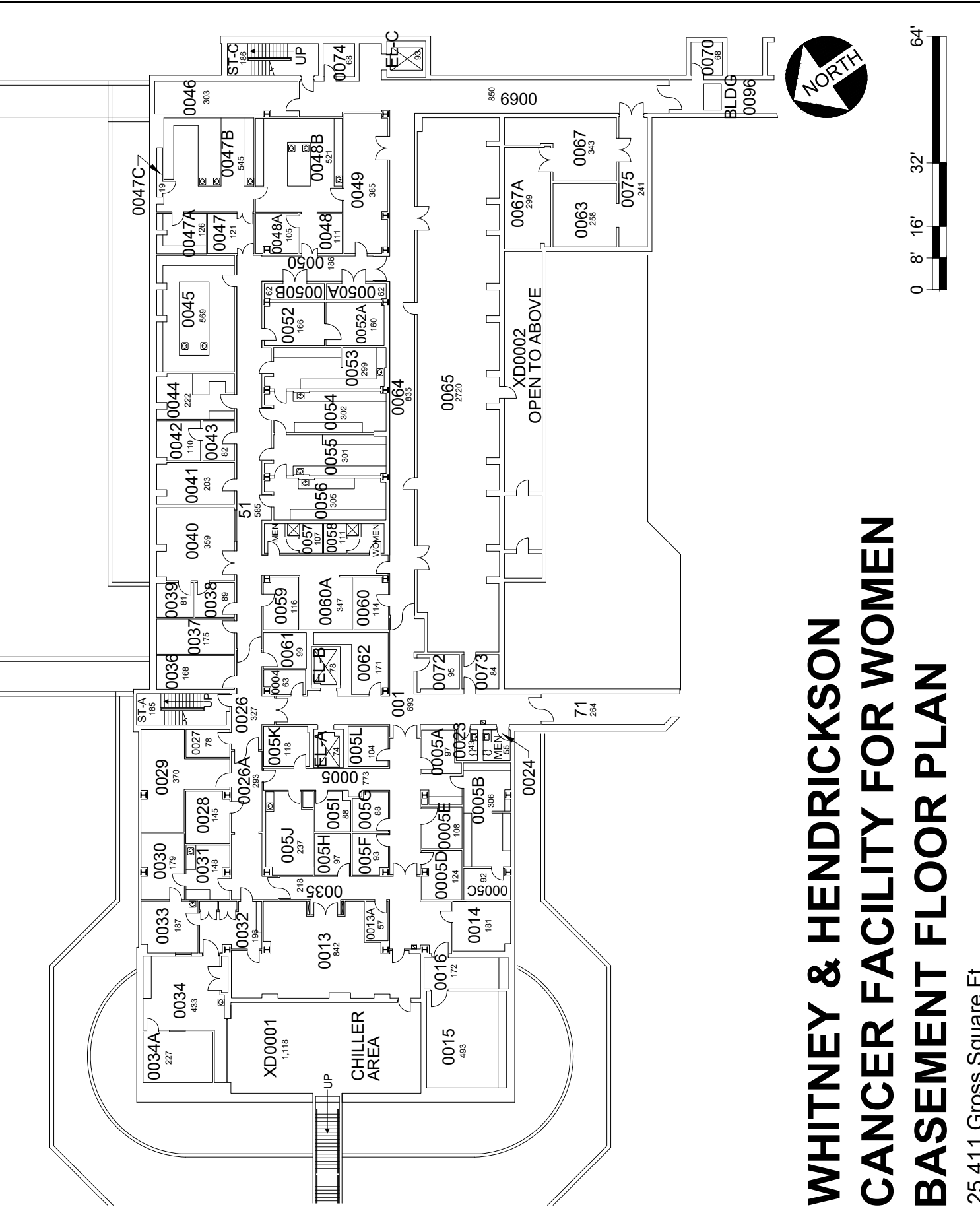

# WHITNEY & HENDRICKSON CANCER FACILITY FOR WOMEN BASEMENT FLOOR PLAN

25,411 Gross Square Ft.

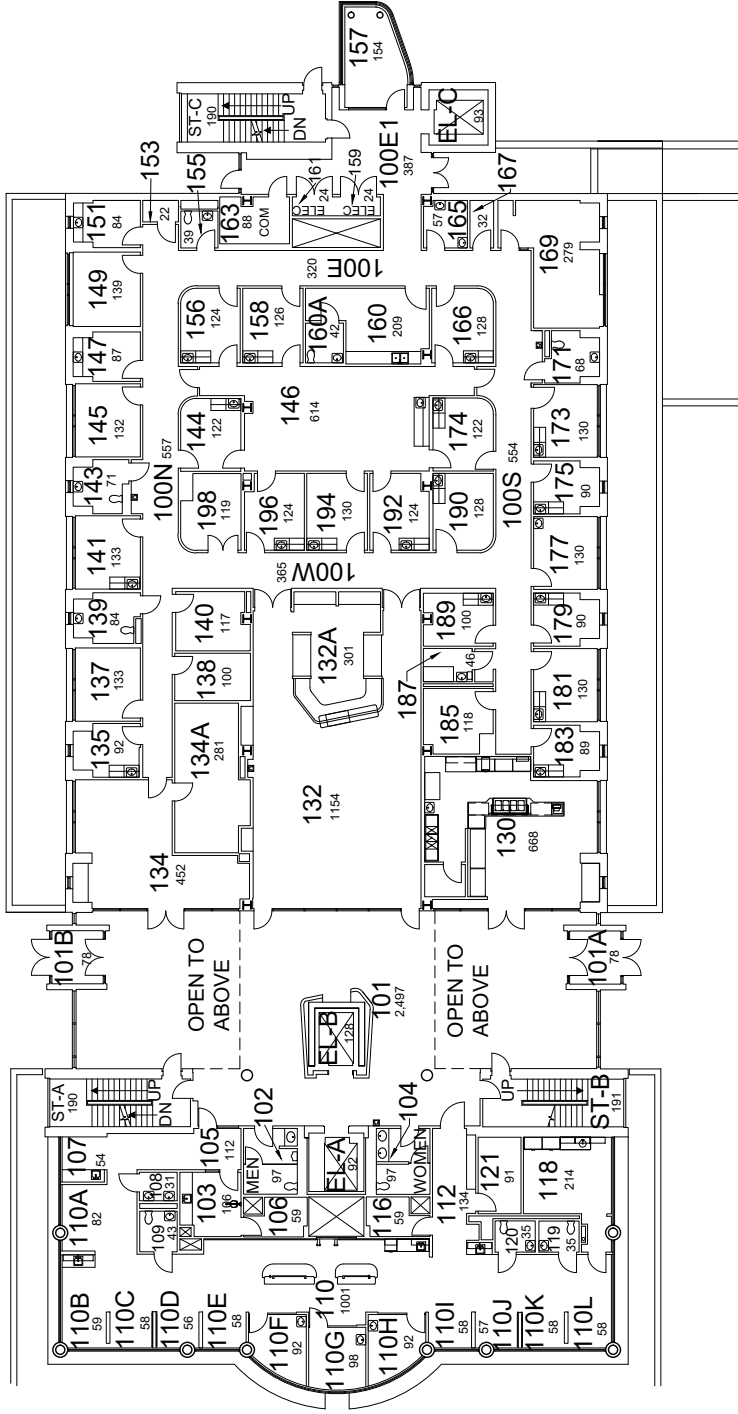

# WHITNEY & HENDRICKSON CANCER FACILITY FOR WOMEN FIRST FLOOR PLAN

18,756 Gross Square Ft.

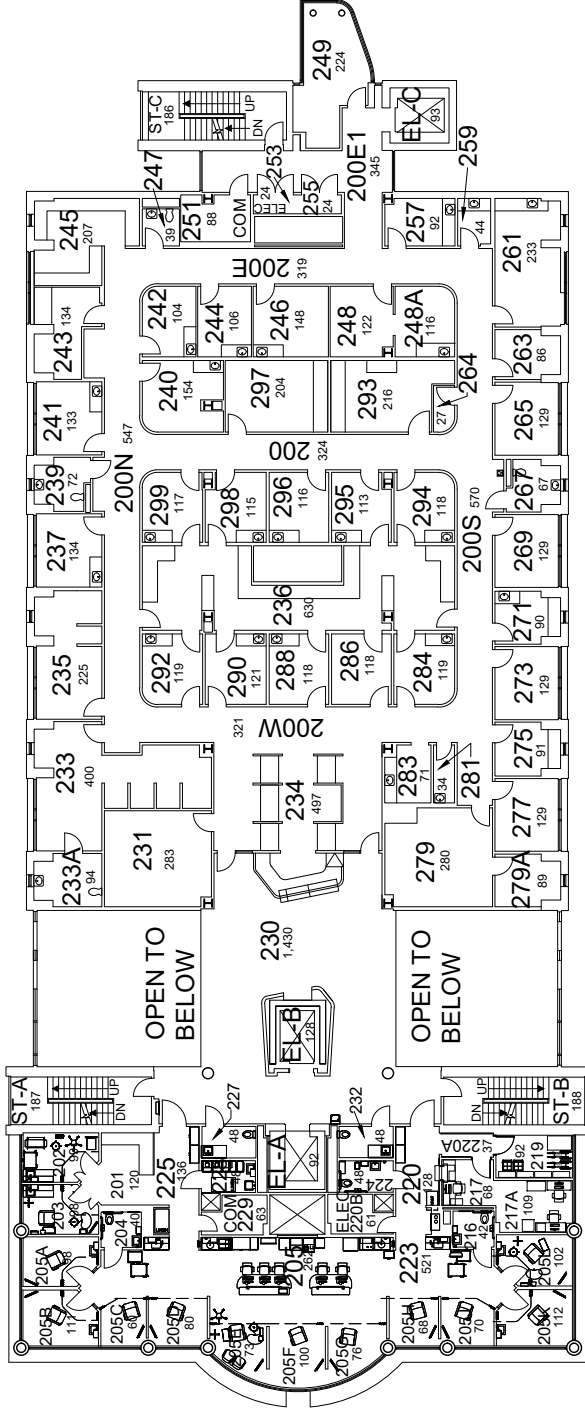

# WHITNEY & HENDRICKSON CANCER FACILITY FOR WOMEN SECOND FLOOR PLAN

17,266 Gross Square Ft.

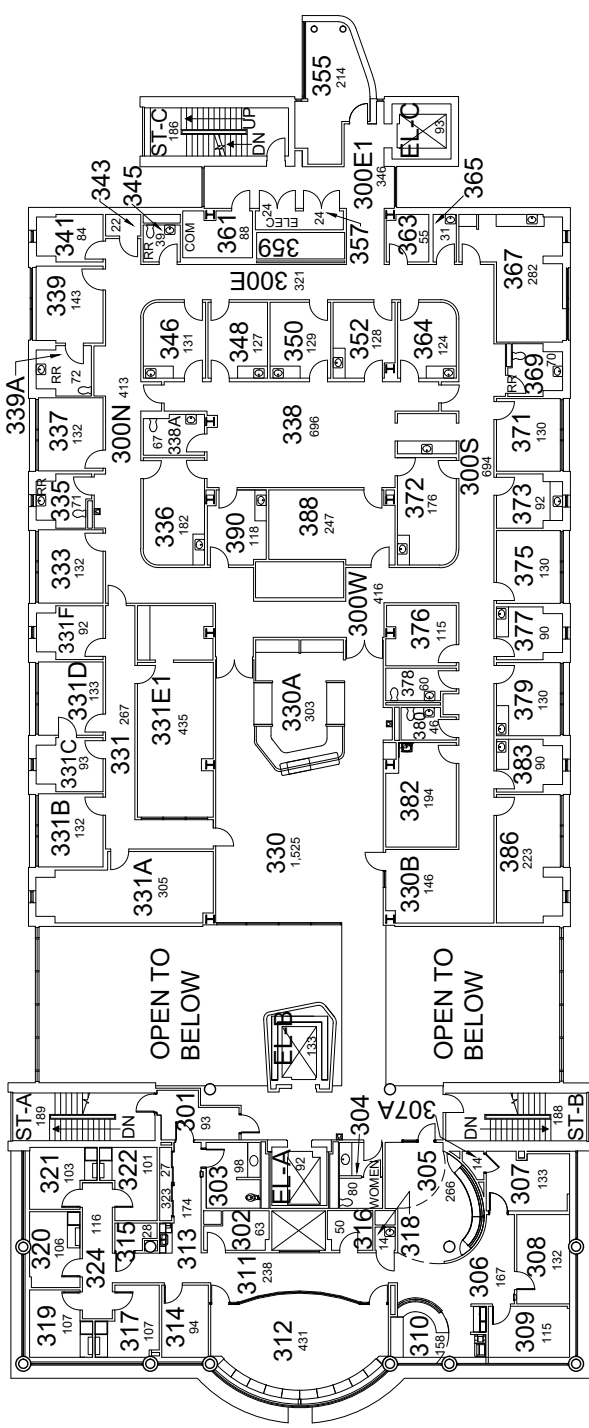

# WHITNEY & HENDRICKSON CANCER FACILITY FOR WOMEN THIRD FLOOR PLAN

17,267 Gross Square Ft.



DATE:  
08-25-12  
DRAWN BY:  
SK

BLDG #:  
0098

WHITNEY & HENDRICKSON CANCER FACILITY FOR WOMEN

KEY DRAWING

UNIVERSITY OF KENTUCKY  
Facilities Information Services



SHEET  
5 OF 6

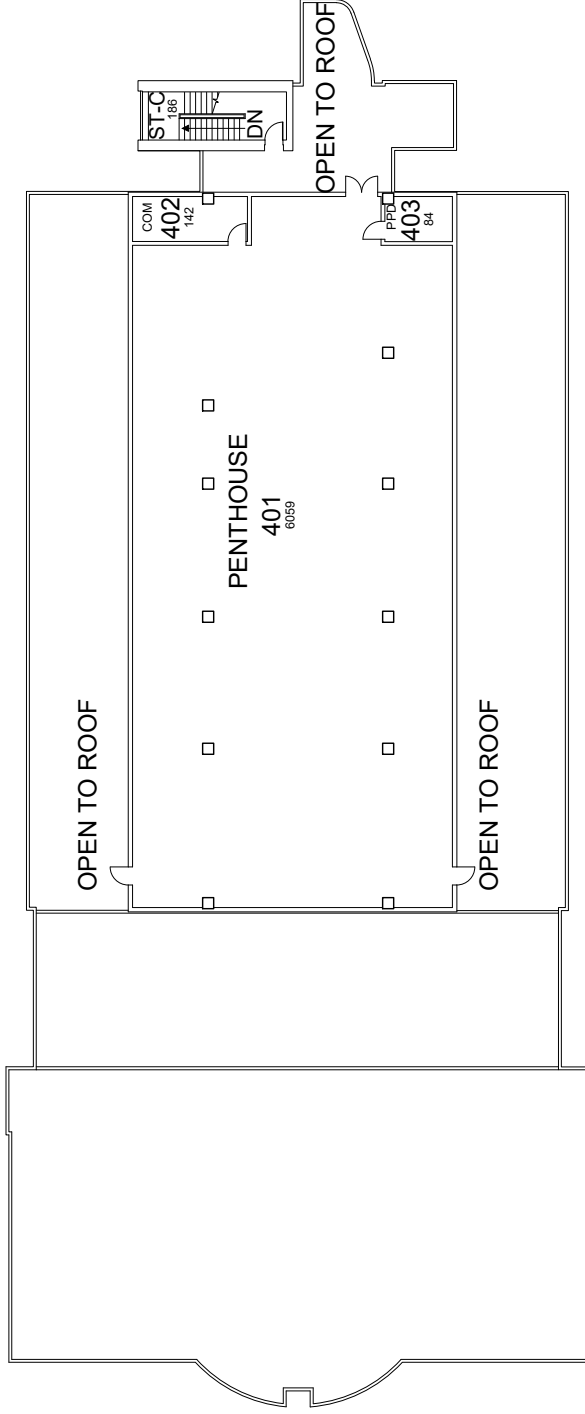

# WHITNEY & HENDRICKSON CANCER FACILITY FOR WOMEN PENTHOUSE FLOOR PLAN

6,863 Gross Square Ft.

DATE: 08-25-12  
DRAWN BY: SK

WHITNEY & HENDRICKSON CANCER FACILITY FOR WOMEN  
BLDG #: 0098  
KEY DRAWING

UNIVERSITY OF KENTUCKY  
Facilities Information Services



SHEET 6 OF 6

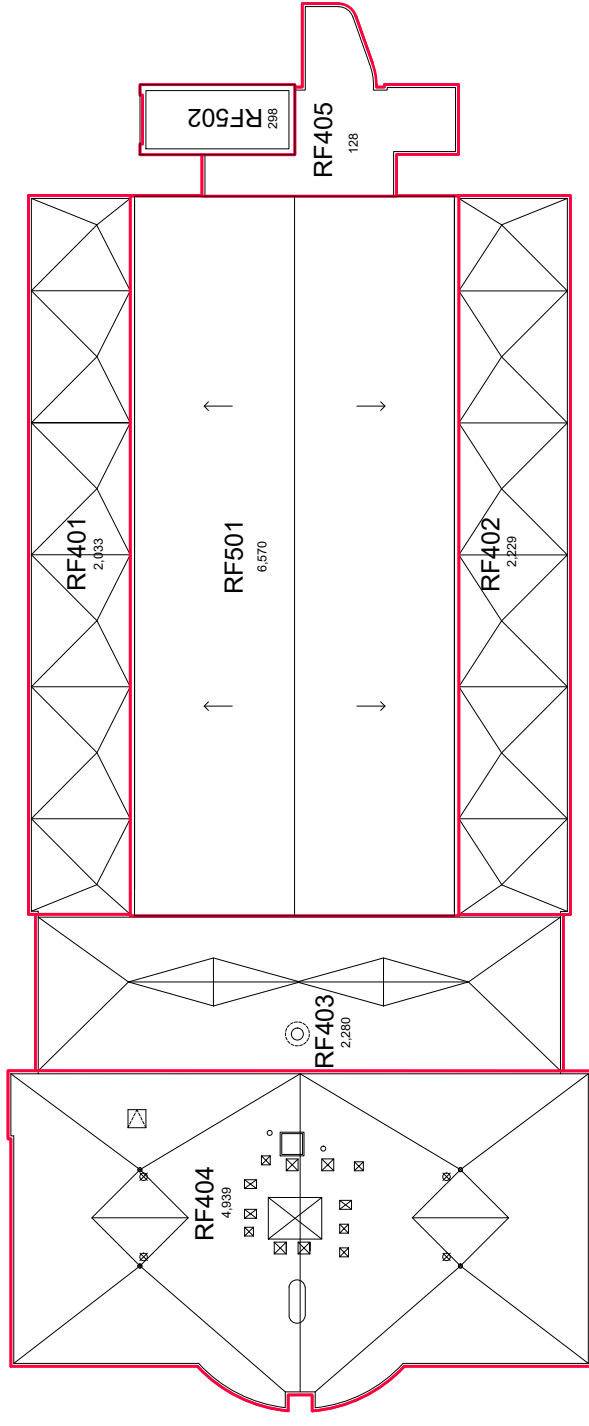

# WHITNEY & HENDRICKSON CANCER FACILITY FOR WOMEN ROOF FLOOR PLAN